

Arkansas Municipal League

83rd Convention
Program and
Exhibitor Guide



#83rdAMLConv

Table of Contents

Maps	4
President’s Welcome	7
2016-2017 Officers	8
Advisory Council Chairs	9
Executive Committee	10
Past Presidents Advisory Council	10
Advisory Councils	12
League Past Presidents 1935—2016.	14
#83rdAMLConv Agenda	
Wednesday	16
Thursday	18
Friday	26
Thank You to Our League Sponsors	28
Thank You to Our League Advertisers	30
Exhibitor Guide.	44
In Memoriam	58

Convention Center Maps

MEETING ROOMS BALLROOM LEVEL

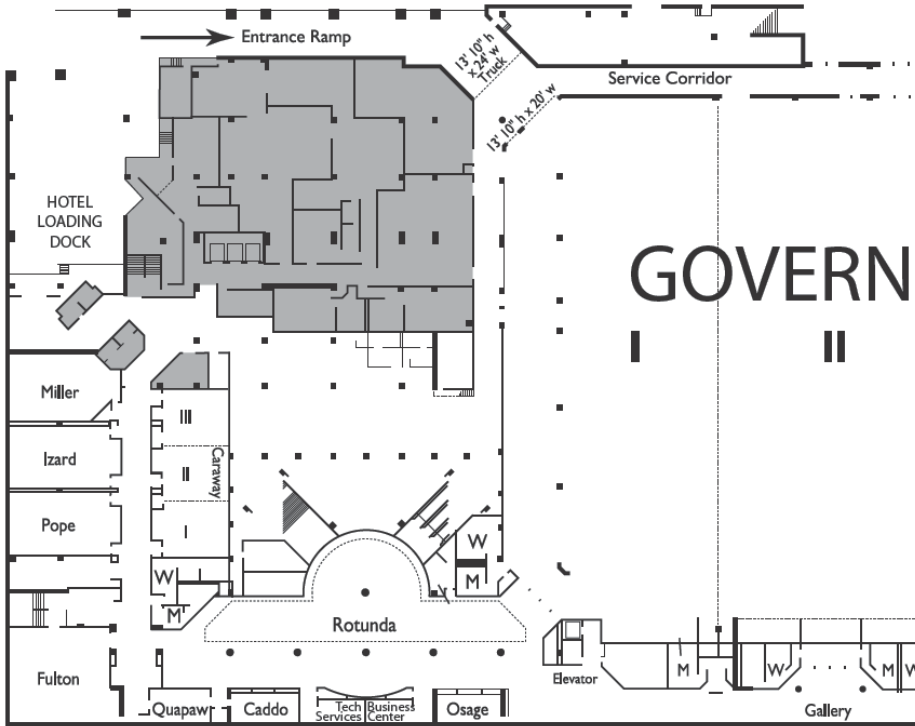

EXHIBITION HALLS AND MEETING ROOMS

Convention Center Maps

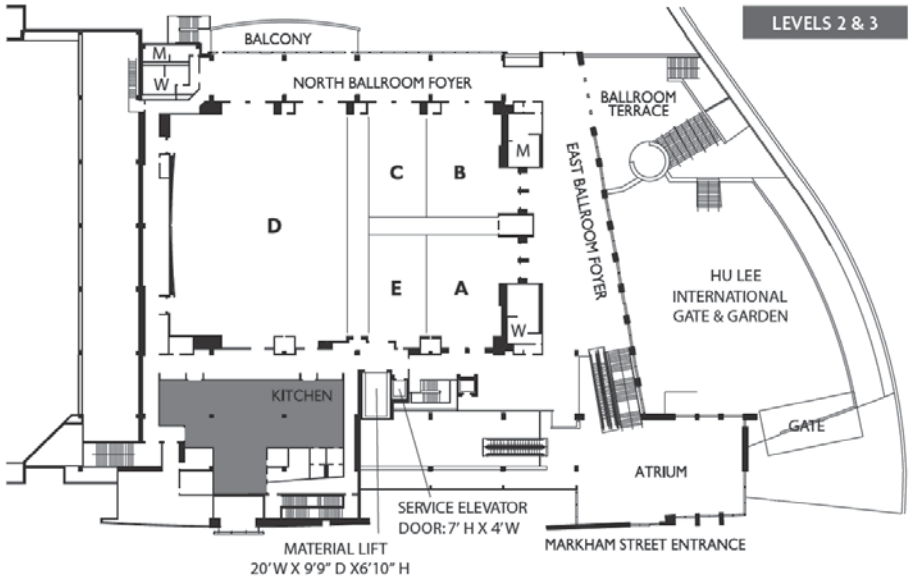

WALLY ALLEN BALLROOM STATEHOUSE CONVENTION CENTER

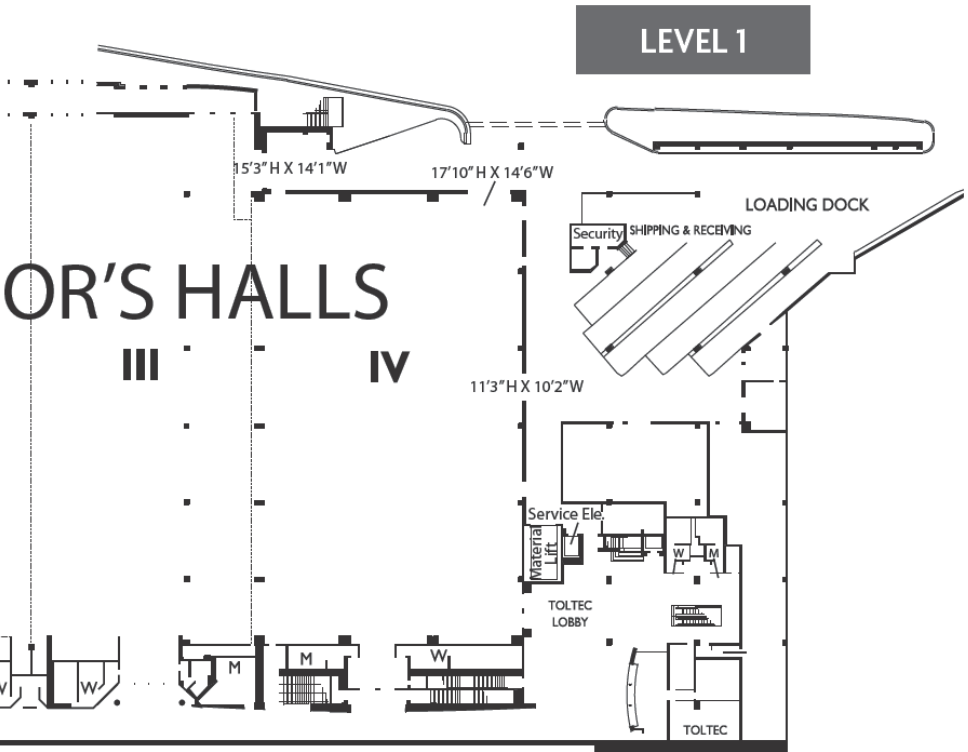

STATEHOUSE CONVENTION CENTER

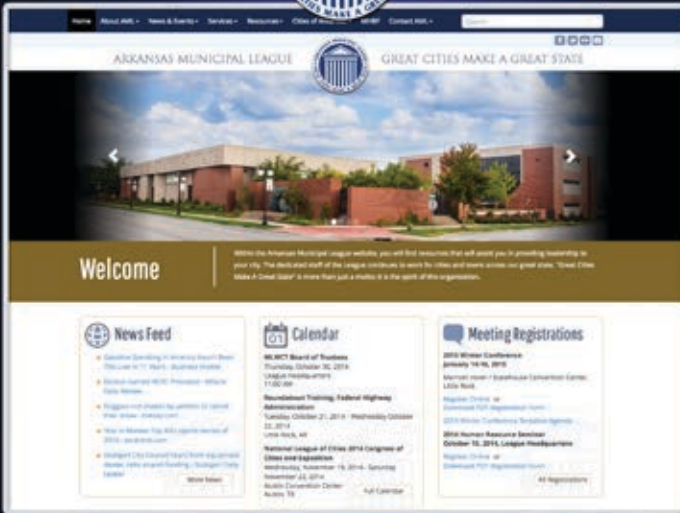

www.arml.org



[Facebook.com/Arkansas.Municipal.League](https://www.facebook.com/Arkansas.Municipal.League)



[Twitter @ARMuniLeague](https://twitter.com/ARMuniLeague)



[Linkedin Arkansas Municipal League](https://www.linkedin.com/company/Arkansas-Municipal-League)



[Instagram armunileague](https://www.instagram.com/armunileague)



[Youtube.com/user/ARMunicipalLeague](https://www.youtube.com/user/ARMunicipalLeague)



[Flickr.com/photos/arkansas_municipal_league](https://www.flickr.com/photos/arkansas_municipal_league)



[greatcitiesgreatstate.com \(microsite\)](http://greatcitiesgreatstate.com)

Great Cities Make a Great State!

Arkansas Municipal League

P.O. Box 38

North Little Rock, AR 72115

301 W. Second St.

North Little Rock, AR 72114

501-374-3484

Email: citytown@arml.org

Mayor Harry Brown
Stephens
President



Dear Friends:

Welcome to the 83rd Convention of the Arkansas Municipal League. As you review your program, you will see the outstanding agenda Don Zimmerman and the League staff have organized.

We begin with the “Discovering Your Leadership Strengths” by speaker Jim Mathis, at 2:30 p.m. on Wednesday. At that evening’s Opening Night Banquet we’re honored to have House Speaker Jeremy Gillam addressing us.

Thursday brings a full day of general sessions featuring excellent speakers and workshops covering a variety of issues that we face daily in our cities and towns. We’re excited to hear from best-selling author Neal Petersen during the Opening General Session at 8:45 a.m. Thursday. Don’t miss the Governor’s remarks later that morning.

The Awards and New Officers’ Luncheon on Friday will give us the opportunity to meet the officers who will lead this great organization for the next year.

Our host cities, Little Rock and North Little Rock, are excited to host our 83rd Convention. Be sure to take advantage of the wonderful restaurants, shops, and attractions the two cities have to offer during your visit.

Thank you for attending, and enjoy the League’s 83rd Convention. “Great Cities Make a Great State.”

Sincerely,

A handwritten signature in blue ink, appearing to read "Harry Brown Stephens". The signature is stylized and includes a long horizontal line extending to the right.

President,
Arkansas Municipal League

2016-2017 Vice Presidents



Mayor Doug Sprouse
Springdale
First Vice President



Mayor Jimmy Williams
Marianna
Vice President, District 1



Mayor Jill Dabbs
Bryant
Vice President, District 2



Vice Mayor Kevin Settle
Fort Smith
Vice President, District 3



Mayor Gary Baxter
Mulberry
Vice President, District 4

Advisory Council Chairs



Mayor Virginia Young
Sherwood
Large First Class Cities



Mayor Bob Stacy
Wynne
First Class Cities



Mayor Darrell Kirby
Bay
Second Class Cities



Mayor Dennis Behling
Lakeview
Small Cities and Towns



City Manager Catherine Cook
Hope
Public Safety



Alderman James Moore
Magnolia
Economic Development



Don A. Zimmerman
Executive Director
Arkansas Municipal League

Arkansas Municipal League



Mayor
Veronica Post
Altus



Mayor
Tim McKinney
Berryville



Mayor
James Sanders
Blytheville



Clerk/Treasurer
Barbara Blackard
Clarksville



Mayor
Scott McCormick
Crossett



Mayor
Billy Ray McKelvy
De Queen



Mayor
Johnny Brigham
Dumas



Mayor
Frank Hash
El Dorado



Mayor
Paul Wellenberger
Fairfield Bay



Mayor
Lioneld Jordan
Fayetteville



Mayor
Larry Bryant
Forrest City



Mayor
Kevin Johnston
Gentry

Arkansas Municipal League



Mayor
Robert Patrick
St. Charles
2003-2004



Mayor
Mike Gaskill
Paragould
2007-2008



Mayor
JoAnne Bush
Lake Village
2008-2009



Alderman
Murry Witcher
North Little Rock
2010-2011

Executive Committee



Alderman
Reddie Ray
Jacksonville



Mayor
Harold Perrin
Jonesboro



Alderman
Sam Angel II
Lake Village



Mayor
Jerry Boen
Lamar



Mayor
Mike Watson
Maumelle



Mayor
Joe Dillard
Mountain Home



Mayor
Joe Smith
North Little Rock



Alderman
Steven Mays
Pine Buff



Mayor
Sonny Hudson
Prairie Grove



Mayor
David Morris
Searcy



Mayor
Mike Kemp
Shannon Hills



Alderman
Dorothy Henderson
Warren

Past Presidents Advisory Council



Mayor
Frank Fogleman
Marion
2011-2012



Mayor
Jackie Crabtree
Pea Ridge
2013-2014



Mayor
Mark Stodola
Little Rock
2014-2015



Mayor
Rick Elumbaugh
Batesville
2015-2016

LARGE FIRST CLASS CITIES ADVISORY COUNCIL: Mayor Virginia Young, **Sherwood**, Chair; Mayor James Calhoun, **Arkadelphia**; City Clerk/Treasurer Denise Johnston, **Batesville**; Aldermen Ann Gilliam, Eddie Long and Ron Waymack, **Cabot**; Mayor Marie Trisollini, **Camden**; Chief of Staff Don Marr and Director of Communications Susan Norton, **Fayetteville**; Assistant City Manager Lance Spicer, **Hot Springs**; Mayor Gary Fletcher and Alderman Kenny Elliott, **Jacksonville**; Aldermen Chris Gibson and John Street, **Jonesboro**; Intergovernmental Relations Manager Emily Cox, **Little Rock**; Clerk/Treasurer Diane Whitbey and Aldermen Debi Ross and Beth White, **North Little Rock**; Alderman Joshua Agee, **Paragould**; Mayor Randy Horton and Clerk/Treasurer Kathy Collins, **Russellville**; Alderman Marina Brooks, **Sherwood**; Mayor John Mark Turner, **Siloam Springs**; Vice Mayor Laney Harris, **Texarkana**

FIRST CLASS CITIES ADVISORY COUNCIL: Mayor Bob Stacy, **Wynne**, Chair; City Director Bruce Farrar, **Barling**; Clerk/Treasurer Carol Westergren, **Beebe**; Mayor Kenneth Jones, **Brookland**; Mayor Bill Edwards and Alderman Robin Reed, **Centerton**; Alderman C.T. Foster, **Crossett**; Clerk/Treasurer Donna Jones, **De Queen**; Mayor Ralph Relyea, **DeWitt**; Aldermen Ross Martin and T.C. Pickett, **Dumas**; Alderman Kenneth Cross, **Earle**; Mayor Bruce Ledford, **Elkins**; Mayor Doug Kinslow, **Greenwood**; Mayor Jon Milligan and Clerk/Treasurer Linda Simpson, **Lake City**; Clerk/Treasurer Ruth Keith, **Leachville**; Alderman Loye Free, **Marianna**; Alderman James Turner and Assistant to Mayor Becky Horton, **Mena**; Mayor Allen Lipsmeyer and Alderman John Payne, **Morrilton**; Mayor Jim Poole, **Piggott**; Alderman Doug Bartholomew, **Prairie Grove**; Clerk/Treasurer Mitri Greenhill, **Stuttgart**; Mayor Art Brooke, **Ward**

SECOND CLASS CITIES ADVISORY COUNCIL: Mayor Darrell Kirby, **Bay**, Chair; Alderman Larry Hall, **Bay**; Mayor Ronnie Guthrie, **Calico Rock**; Mayor Barry Riley, **Caraway**; Alderman Richard Hawkins II, **Cave City**; Mayor Phillip Moudy, **Danville**; Mayor Jeff Braim, **Gassville**; Alderman Gary Khoury, **Greers Ferry**; Recorder/Treasurer Mary Ruth Wiles, **Highland**; Alderman John Grochowski, **Horseshoe Bend**; Mayor Buddy Blue, **Little Flock**; Mayor Steve Dixon, **Marmaduke**; Mayor Terrie Triplet, **McNeil**; Mayor Jim Crotty, **Norphlet**; Recorder/Treasurer Dane Fults, **Redfield**; Mayor Bobby Neal and Recorder/Treasurer Rick East, **Smackover**; Mayor Patricia Glover and Alderman Rickey Lambert, **Waldo**; Aldermen Tena Brooks and A.C. Loring, **Wrightsville**

SMALL CITIES AND TOWNS ADVISORY COUNCIL: Mayor Dennis Behling, **Lakeview**, Chair; Alderman Dona Burton, **Caddo Valley**; Mayor Bobby Box Sr., **Chidester**; Mayor Michael Lester, **Gum Springs**; Mayor Marion Hoosier, **McCaskill**; Mayor Carroll Shipman and Recorder/Treasurer Bobby Brown, **McDougal**; Mayor Robert Sullivan, **McRae**; Alderman Don Sappington, **Norfolk**; Mayor Phillip Freeman and Recorder/Treasurer Rita Fite, **Sparkman**; Recorder/Treasurer Naomi Mitchell, **St. Charles**; Assistant to Mayor Pamela Dawkins, **Strong**; Mayor Billy Burns, **Sulphur Rock**; Mayor Charles Miller, **Tollette**; Mayor Namon Goff, **Twin Groves**; Mayor Curley Jackson and Alderman Marvin Hopson, Sr., **Wilmar**

PUBLIC SAFETY ADVISORY COUNCIL: City Manager Catherine Cook, **Hope**, Chair; Alderman Jim Wozniak, **Bella Vista**; Alderman Stan Parks, **Blytheville**; Alderman Doug Warner, **Cabot**; Police Chief Kevin Weathers, **Clarksville**; Fire Chief Chad Mosby, **El Dorado**; Alderman Ralph Bird, Fire Chief Bill Johnson and Police Chief Tim Mayfield, **Gassville**; Mayor Sherry Kelly, **Gurdon**; Fire Chief Josh “Moose” Dunavan and Police Chief Jesse Martinez, **Little Flock**; Assistant Police Chief Alice Fulk, **Little Rock**; Aldermen Jess Holt and Marc Kelley, **Maumelle**; Fire Chief Kevin Lang, **Paragould**; Alderman Betty Cook, **Sheridan**; Alderman Ken Keplinger, **Sherwood**; Alderman James Pulliam, **West Memphis**

ECONOMIC DEVELOPMENT ADVISORY COUNCIL: Alderman James Moore, **Magnolia**, Chair; Mayor Peter Christie, **Bella Vista**; Mayor Bob McCaslin, **Bentonville**; Mayor Danny Shaw, **Bono**; Alderman Kevin Davis, **Cabot**; Mayor Mark Simpson, **Clarksville**; Alderman Dianne Hammond, **El Dorado**; Mayor Michael Cravens, **Elaine**; Clerk/Treasurer Derene Cochran and Alderman Louise Fields, **Forrest City**; Mayor Essie Dale Cableton and Alderman Retha Spencer, **Gould**; Alderman Rose Marie Wilkinson, **Haskell**; City Director Becca Clark, **Hot Springs**; Mayor Carl Griswold, **Mitchellville**; Alderman Beverly Williams, **Sherwood**; City Administrator Phillip Patterson and City Director Bob Coleman, **Siloam Springs**; Clerk/Treasurer Pam Cawthon, **Tuckerman**; Deputy Operations Director Charles Gastineau, **Ward**

MUNICIPAL HEALTH BENEFIT FUND BOARD OF TRUSTEES: Clerk/Treasurer Mitri Greenhill, **Stuttgart**, District 1; Mayor Gary Fletcher, **Jacksonville**, District 2; Mayor Randy Horton, **Russellville**, District 3; City Clerk Rendi Currey, **Arkadelphia**, District 4; Mayor Parnell Vann, **Magnolia**, At-Large Member

MUNICIPAL LEAGUE WORKERS’ COMPENSATION TRUST BOARD OF TRUSTEES: Mayor William Johnson, **West Memphis**, District 1; Human Resources Director Lisa Mabry-Williams, **Conway**, District 2; Clerk/Treasurer Sondra Smith, **Fayetteville**, District 3; Mayor Bryan Martin, **Warren**, District 4; City Attorney Howard Cain, **Huntsville**, At-Large Member and Group Manager

PENSION MANAGEMENT AND OPEB TRUSTS, BOARD OF TRUSTEES: Finance Director Karen Scott, **North Little Rock**, Chairman; Treasury Manager Scott Massanelli, **Little Rock**, Vice Chair; Clerk/Treasurer Carol Westergren, **Beebe**; Comptroller Mandy Spicer, **Benton**; Finance Director Joy Black, **Bryant**

Arkansas Municipal League

1935—Mayor U.E. Moore	North Little Rock
1936—Mayor Jim Jordan	Fort Smith
1937—Mayor R.E. Overman	Little Rock
1938—City Manager C.C. Mitchener	Marianna
1939—Mayor H.C. Stump	Stuttgart
1940—Mayor A.D. McAllister	Fayetteville
1941—Mayor J.V. Satterfield	Little Rock
1941—Mayor Tom Cashion	Eudora
1942—Mayor H.O. Walker	Newport
1943—Mayor Chester Holland	Fort Smith
1944—Alderman Sam M. Wassell	Little Rock
1945—Mayor Jim Dandridge	Paris
1946—Mayor R.C. Bodenhamer	El Dorado
1947—Mayor Don Harrell	Camden
1948—Mayor James Hurley	Warren
1949—Mayor Earl Ricks	Hot Springs
1949—Mayor George Steed	Pine Bluff
1950—Mayor B.R. McCarley	Texarkana
1951—Mayor Harney Chaney	Batesville
1952—Mayor Harold Falls	Wynne
1953—Mayor James T. Horner	Helena
1954—City Clerk H.C. Graham	Little Rock
1955—Mayor Wm. L. Ward Jr.	Marianna
1956—Mayor H.R. Hestand	Fort Smith
1957—Mayor H.B. Price	West Memphis
1958—Mayor Ben F. Butler	Osceola
1959—Mayor Wm. F. Laman	North Little Rock
1960—Mayor John Harsh	Magnolia
1961—Commissioner Hugh Brewer	Fort Smith
1962—Mayor Roy Row	Batesville
1963—Mayor Billy Free	Dumas
1964—Mayor Allen Ray Toothaker	Van Buren
1965—Mayor Clyde Andrews	Marianna
1966—Mayor Vaskell Carter	Crossett
1967—Mayor John Bueker	Stuttgart
1968—Mayor C.A. Hughes	Russellville
1968/1969—Mayor Jesse Porter	West Helena
1970—Mayor Flynn Chivers	Clarendon
1971—Mayor Adrian White	Pocahontas
1972—Mayor Ed M. Bautts	Rogers
1973—Mayor Tom Little Jr.	Blytheville
1974—Mayor Leslie Carmichael	Searcy
1975—Mayor Tom Ellsworth	Hot Springs
1976—Mayor Neil Stallings	Jonesboro
1977—Mayor Harry Kolb	Magnolia
1978—Mayor James Jordan	Monticello

Past Presidents 1935—2015

1980—Mayor Charles Moore	Pine Bluff
1980—Mayor R.E. (Dick) Prewitt.	Osceola
1981—Mayor Jack R. Rhodes	Lake Village
1982—Mayor John Schallhorn	DeWitt
1983—Mayor Charles Partlow	Paragould
1984—Mayor Thad Kelly Jr.	Helena
1984/1985—Mayor Gene Bell.	Van Buren
1985/1986—Mayor Dean Boswell Jr.	Bryant
1986/1987—Mayor Larry Combs	El Dorado
1987/1988—Mayor Jim Shirrell	Batesville
1988—Mayor Marilyn Johnson.	Fayetteville
1989/1990—Mayor Eugene Farrell	Dermott
1990/1991—Alderman Martin Gipson	North Little Rock
1991/1992—Mayor Bob Teeter	West Helena
1992/1993—Mayor Marvin Vinson.	Clarksville
1993/1994—Mayor Bill Scrimshire.	Malvern
1994/1995—Mayor Patrick Henry Hays	North Little Rock
1995/1996—Mayor Joann Smith.	Helena
1996/1997—Mayor Arnold Feller.	Mulberry
1997/1998—Mayor Gregg Reep	Warren
1998/1999—Mayor Tommy Swaim	Jacksonville
1999/2000—Alderman Tommy Baker	Osceola
2000/2001—Mayor Harold West.	Monticello
2001/2002—Mayor George Overbey Jr.	Lamar
2002/2003—Mayor Jim Dailey	Little Rock
2003/2004—Mayor Robert Patrick.	St. Charles
2004/2005—Mayor Gene Yarbrough.	Star City
2005/2006—Mayor Terry Coberly	Bentonville
2006—Mayor Stewart Nelson	Morrilton
2007—Mayor Tab Townsell	Conway
2007/2008—Mayor Mike Gaskill	Paragould
2008/2009—Mayor JoAnne Bush	Lake Village
2009/2010—Vice Mayor Gary Campbell.	Fort Smith
2010/2011—Alderman Murry Witcher	North Little Rock
2011/2012—Mayor Frank Fogleman.	Marion
2012/2013—Mayor Chris Claybaker.	Camden
2013/2014—Mayor Jackie Crabtree	Pea Ridge
2014/2015—Mayor Mark Stodola	Little Rock
2015/2016—Mayor Rick Elumbaugh.	Batesville

<p>1:00 P.M. to 7:00 P.M.</p>	<p>REGISTRATION</p> <p><i>(Be sure to download the League's meeting App onto your smart device. Search for "AML" in your App Store.)</i></p>	<p>OSAGE & CADDOROOMS, SCC</p>
<p>1:00 P.M. to 6:45 P.M.</p>	<p>MEET YOUR EXHIBITORS/RENEW ACQUAINTANCES</p> <p><i>Use this time to meet the exhibitors and see what products and services they have that could benefit your city. Popcorn and cool beverages will be served throughout the afternoon. Also, take the time to renew acquaintances with fellow municipal officials while relaxing in the Exhibit Hall.</i></p>	<p>GOVERNOR'S HALLS I - III, SCC</p>
<p>1:30 P.M. to 3:30 P.M.</p>	<p>ARKANSAS CITY CLERKS, RECORDERS, AND TREASURERS ASSOCIATION</p>	<p>ARKANSAS BALLROOM, MH</p>
<p>2:30 P.M. to 5:15 P.M.</p>	<p>DISCOVERING YOUR LEADERSHIP STRENGTHS</p> <p><i>Every municipal leader can learn how to work together in a more professional manner. Attendees will hear Jim Mathis talk about some of the essential tools for managing, leading and communicating. Discover the strengths of your leadership style.</i></p> <p>(3 Continuing Education Hours)</p> <p>Presiding: Mayor Harry Brown, Stephens President Arkansas Municipal League</p> <p>Speaker: Jim Mathis, Best-selling Author J&L Mathis Group, Inc.</p> <p>Sponsored by: Raymond James Centennial Bank</p>	<p>GOVERNOR'S HALL IV, SCC</p>
<p>5:15 P.M. to 5:30 P.M.</p>	<p>REPORT FROM THE ARKANSAS TREASURER OF STATE</p> <p>Speaker: Honorable Dennis Milligan, Treasurer State of Arkansas</p>	<p>GOVERNOR'S HALL IV, SCC</p>
<p>*MH = Marriott Hotel *SCC = Statehouse Convention Center</p>		

Jim Mathis

Facebook: jim.mathis.7

Twitter: @jimmathis

Dennis Milligan

Facebook: Arkansas Treasurer of State Dennis Milligan

Twitter: @ARTreasurer

<p>3:30 P.M. to 5:00 P.M.</p>	<p>INTERIM JOINT CITY, COUNTY, LOCAL AFFAIRS COMMITTEE</p> <p><i>City officials are welcome to attend this interim legislative committee meeting.</i></p>	<p>FULTON ROOM, SCC</p>
<p>5:30 P.M. to 6:30 P.M.</p>	<p>RESOLUTIONS COMMITTEE</p> <p><i>Each municipality has a designated representative who is a member of the Resolutions Committee.</i></p> <p>Presiding: Mayor Doug Sprouse, Springdale First Vice President Arkansas Municipal League</p>	<p>GOVERNOR'S HALL IV, SCC</p>
<p>7:00 P.M.</p>	<p>OPENING NIGHT BANQUET</p> <p><i>Welcome to the 83rd Annual Convention's Opening Night Banquet. Enjoy a delicious meal and visit with fellow delegates. Speaker Gillam will address the group, and the State and Local Legal Center's Lisa Soronen will update us on U.S. Supreme Court issues. Various legislators and individuals who have made significant contributions to the cities and towns of Arkansas will be recognized.</i></p> <p>Presiding: Mayor Harry Brown, Stephens President Arkansas Municipal League</p> <p>Invocating: Mayor Doug Sprouse, Springdale First Vice President Arkansas Municipal League</p> <p>Speakers: Honorable Jeremy Gillam Speaker of the House State Representative, District 45 Lisa Soronen, Executive Director State and Local Legal Center</p>	<p>WALLY ALLEN BALLROOM, SCC</p>
<p>8:30 P.M.</p>	<p>POST BANQUET RECEPTION</p> <p><i>After the opening night banquet, stroll over and enjoy delicious desserts at the historic Capital Hotel.</i></p> <p>Sponsored by: Stephens Inc.</p>	<p>CAPITAL HOTEL</p>

*MH = Marriott Hotel *SCC = Statehouse Convention Center

Doug Sprouse

Facebook: City of Springdale, AR - Mayor's Office

Twitter: @Springdale_AR

Jeremy Gillam

Facebook: ArkansasHouse

Twitter: @JeremyGillamAR

Lisa Soronen

Facebook: Lisa Soronen

Twitter: @SLLCSCOTUS

7:00 A.M. to 5:30 P.M.	REGISTRATION <i>(Be sure to download the League's meeting App onto your smart device. Search for "AML" in your App Store.)</i>	OSAGE ROOM, SCC
7:00 A.M. to 5:30 P.M.	EXHIBITS OPEN	GOVERNOR'S HALLS I - III, SCC
7:00 A.M. to 8:30 A.M.	HOST CITY BREAKFAST BUFFET Sponsored by: City of Little Rock	GOVERNOR'S HALLS I - III, SCC
7:15 A.M. to 7:30 A.M.	VOLUNTARY PRAYER SESSION <i>This is a brief time set aside for those who wish to gather to pray for our national, state and local leaders.</i>	ARKANSAS BALLROOM, MH
8:15 A.M.	CONTINUING LEGAL EDUCATION <i>City attorneys will receive 12 hours of CLE credit for participation in two days of meetings.</i>	LEAGUE HEADQUARTERS
8:45 A.M. to 10:15 A.M.	OPENING GENERAL SESSION I <i>The 83rd Annual Convention begins with the posting of the colors and the singing of the National Anthem, followed by a Host City Welcome from Mayor Mark Stodola of Little Rock. Motivational speaker Neal Petersen's topic will be "No Barriers-Only Solutions-Working Together."</i>	GOVERNOR'S HALL IV, SCC
  	<p>Presiding: Mayor Harry Brown, Stephens President Arkansas Municipal League</p> <p>Color Guard by: Little Rock Fire Department Color Guard National Anthem: Officer Allison Walton Little Rock Police Department</p> <p>Host City Welcome Address: Mayor Mark Stodola Little Rock</p> <p>Speakers: Neal Petersen, Best-selling Author and Motivational Speaker Beth Van Duyne, HUD Regional Administrator for Region VI</p> <p>Sponsored by: Arvest Bank Mitchell Williams Law Firm</p>	
10:15 A.M. to 10:30 A.M.	BREAK <i>Soft drinks and coffee available in the Exhibit Hall.</i>	GOVERNOR'S HALLS I - III, SCC

*MH = Marriott Hotel *SCC = Statehouse Convention Center

Mark Stodola

Facebook: City of Little Rock, AR - Government
Twitter: @CityLittleRock

Neal Petersen

Facebook: Neal Petersen's No Barriers

Beth Van Duyne

Facebook: Beth Van Duyne
Twitter: @Bethvanduyne

<p>10:30 A.M. to 11:15 A.M.</p>   	<p>GENERAL SESSION 2 THE IMPACT OF NEW GUN LAWS AND MEDICAL MARIJUANA</p> <p><i>The new gun laws and medical marijuana amendment will be discussed in this session. We will hear from the state's chief law enforcement officer on the new gun laws, followed by information from an expert in the medical marijuana arena.</i></p> <p>Presiding: Mayor Doug Sprouse, Springdale First Vice President Arkansas Municipal League</p> <p>Speakers: Honorable Leslie Rutledge Attorney General State of Arkansas Jeff Sims, President a'TEST Consultants</p>	<p>GOVERNOR'S HALL IV, SCC</p>
<p>11:15 A.M.</p>  	<p>GENERAL SESSION 3 REMARKS FROM OUR GOVERNOR AND AN OVERVIEW OF THE 91ST GENERAL ASSEMBLY</p> <p><i>The League's Don Zimmerman will summarize the 91st General Assembly and Governor Hutchinson will address the Convention delegates.</i></p> <p>Presiding: Mayor Harry Brown, Stephens President Arkansas Municipal League</p> <p>Speakers: Don Zimmerman, Executive Director Arkansas Municipal League Honorable Asa Hutchinson, Governor State of Arkansas</p>	<p>GOVERNOR'S HALL IV, SCC</p>
<p>12:15 P.M.</p>	<p>LUNCHEON BUFFET</p>	<p>GOVERNOR'S HALLS I - III, SCC</p>

*MH = Marriott Hotel *SCC = Statehouse Convention Center

Leslie Rutledge

Facebook: Arkansas Attorney General Leslie Rutledge
Twitter: @AGRutledge

Jeff Sims

Facebook: a' TEST consultants, inc.

Don Zimmerman

Facebook: Arkansas Municipal League
Twitter: @ARMuniLeague

Asa Hutchinson

Facebook: Governor Asa Hutchinson
Twitter: @AsaHutchinson

CONCURRENT WORKSHOPS		
<p>1:30 P.M. to 2:45 P.M.</p>	<p>1. THE BASICS OF BUDGETING: ARE YOU PREPARED FOR A LEGISLATIVE AUDIT?</p> <p><i>What are the basic building blocks of a municipal budget? Are there things you need to do to prepare for a legislative audit? Were there new acts passed during the last session that might impact the way you budget? The speakers explain.</i></p> <p>Presiding: Mayor Kenneth Jones, Brookland Speakers: Cindy Frizzell, Finance Director Arkansas Municipal League Marti Steel, Deputy Legislative Auditor Arkansas Division of Legislative Audit</p>	<p>WALLY ALLEN BALLROOM A, SCC</p>
<p>1:30 P.M. to 2:45 P.M.</p>	<p>2. THE BENEFITS OF INTERNATIONAL CULTURAL EXCHANGE, SISTER CITIES AND OPPORTUNITIES FOR WORLDWIDE TRADE</p> <p><i>The Sister Cities program provides an opportunity for culture exchange between cities around the world. What about opportunities for developing international trade relations? Attend this session and learn more.</i></p> <p>Presiding: Alderman Doug Matthews, Batesville Speakers: Sherman Banks, Consul General for Ghana Dan Hendrix, President and CEO Arkansas World Trade Center Ghana Delegates</p>	<p>POPE ROOM, SCC</p>
<p>1:30 P.M. to 2:45 P.M.</p>	<p>3. INFORMATION SECURITY AND DATA RECOVERY: WHY IT MATTERS</p> <p><i>In the event of a disaster what disaster recovery plans do you have in place? Is your IT system "hack proof?" Will your plan pass the new Legislative Audit requirements? Security and recovery are critical in today's IT world. Learn what you can do to protect your valuable data.</i></p> <p>Presiding: Mayor Mike Watson, Maumelle Speakers: Chris Hartley, IT Director Arkansas Municipal League Britney Whatley, Manager ACOOP Dave Mims, Consultant The League's IT in a Box</p>	<p>CARAWAY ROOMS III, SCC</p>

*MH = Marriott Hotel *SCC = Statehouse Convention Center

1:30 P.M. to 2:45 P.M.	<p>4. LEGAL TOOLS TO KEEP YOUR CITY CLEAN</p> <p><i>Weed lots and neglected property can ruin the appearance of your city. What legal steps can you take to prevent your city from becoming an eyesore?</i></p> <p>Presiding: Mayor Larry Bryant, Forrest City Speakers: Legal Staff Arkansas Municipal League</p>	WALLY ALLEN BALLROOM B, SCC
1:30 P.M. to 2:45 P.M.	<p>5. PENSION PROGRAMS: APERS, LOPFI, AND THE ARKANSAS DIAMOND PLAN</p> <p><i>Were there new laws passed that might impact municipalities? Listen to representatives from these organizations explain.</i></p> <p>Presiding: City Manager Catherine Cook, Hope Speakers: Gail Stone, Executive Director, APERS David B. Clark, Executive Director, LOPFI Chris Howlett, Executive Director of Employee Benefits, Department of Finance and Administration, Arkansas Diamond Plan</p>	WALLY ALLEN BALLROOM C, SCC
1:30 P.M. to 2:45 P.M.	<p>6. SUBSTANCE ABUSE IN THE WORKPLACE</p> <p><i>The new marijuana laws, substance abuse in the workplace and drug testing are topics that will be discussed.</i></p> <p>Presiding: Mayor Mark Stodola, Little Rock Speakers: Jeff Sims, President, aTEST Consultants David Schoen, Legal Counsel Arkansas Municipal League Lanny Richmond, Staff Attorney Arkansas Municipal League</p>	FULTON ROOM, SCC
1:30 P.M. to 2:45 P.M.	<p>7. PREPARING FOR THE 2020 CENSUS</p> <p><i>The 2020 Census is rapidly approaching. Now is the time to take specific steps to be accurately counted. The speakers explain.</i></p> <p>Presiding: Alderman Kenny Elliott, Jacksonville Speakers: A. J. Kelly, Deputy Secretary of State and General Counsel State of Arkansas Deborah (Toni) Pitchford Intergovernmental Affairs Specialist, Office of Congressional and Intergovernmental Affairs, U.S. Census Bureau Shelby Johnson, Geographic Information Officer, Arkansas GIS Office</p>	IZARD ROOM, SCC
2:45 P.M. to 3:00 P.M.	<p>BREAK</p> <p><i>Soft drinks and coffee available in the Exhibit Hall.</i></p>	GOVERNOR'S HALLS I - III, SCC

*MH = Marriott Hotel *SCC = Statehouse Convention Center

CONCURRENT WORKSHOPS		
<p>3:00 P.M. to 4:15 P.M.</p>	<p>1. DEALING WITH WORKPLACE VIOLENCE AND CREATING A SAFE WORKPLACE</p> <p><i>What steps can you take to prevent workplace violence? What can you do to create a safe, injury-free workplace? The speakers offer their advice.</i></p> <p>Presiding: Vice Mayor Kevin Settle, Fort Smith Speakers: David Baxter, Health and Safety Coordinator Arkansas Municipal League Neil Foreman, Director of Loss Control and Marketing Arkansas Municipal League</p>	<p>CARAWAY ROOMS I-III, SCC</p>
<p>3:00 P.M. to 4:15 P.M.</p>	<p>2. PLANNING AND PREPARING FOR LARGE CAPITAL IMPROVEMENT PROJECTS</p> <p><i>Planning for large capital improvement projects can be confusing. Are there various funding sources to consider? What guidelines should you follow to ensure that you avoid the many traps that exist in preparing for capital improvement projects?</i></p> <p>Presiding: Finance Director Karen Scott North Little Rock Speakers: Daniel Allen, Vice President Raymond James Michele Allgood, Attorney Mitchell, Williams, Selig, Gates & Woodyard, PLLC Jill Drewyor, Attorney Mitchell, Williams, Selig, Gates & Woodyard, PLLC</p>	<p>WALLY ALLEN BALLROOM A, SCC</p>
<p>3:00 P.M. to 4:15 P.M.</p>	<p>3. THE CHALLENGES OF MUNICIPAL HUMAN RESOURCES</p> <p><i>There are numerous human resource challenges. This session will consist of a basic review of several important HR issues, including the ADA and FMLA. How should you go about creating a diverse work place? The speakers explain.</i></p> <p>Presiding: Clerk/Treasurer Barbara Blackard Clarksville Speakers: Legal Staff Arkansas Municipal League Minnie Lenox, Human Resources Director Hot Springs Charles Angel, American Fidelity Assurance Company</p>	<p>POPE ROOM, SCC</p>



*MH = Marriott Hotel *SCC = Statehouse Convention Center

<p>3:00 P.M. to 4:15 P.M.</p>	<p>4. AVOIDING LAWSUITS: IS IT POSSIBLE?</p> <p><i>Lawsuits continue to increase against cities. Are there actions that cities can take to prevent lawsuits? What are some of the new Acts that deal with guns, marijuana and the FOIA, and how do they affect cities?</i></p> <p>Presiding: Mayor Frank Hash, El Dorado Speakers: Legal Staff Arkansas Municipal League</p>	<p>WALLY ALLEN BALLROOM B, SCC</p>
<p>3:00 P.M. to 4:15 P.M.</p>	<p>5. LAND USE: TRENDS, CONCERNS AND BEST PRACTICES</p> <p><i>What were some of the new laws passed this session that might impact your ability to plan? Are there traps to avoid when considering annexation? Are there trends occurring in municipal planning to be concerned about? These and many other topics will be discussed.</i></p> <p>Presiding: City Director Becca Clark, Hot Springs Speakers: Jim vonTungeln, AICP, Planning & Zoning Consultant Arkansas Municipal League Jeff Hawkins, Executive Director NW Arkansas Regional Planning Commission</p>	<p>WALLY ALLEN BALLROOM C, SCC</p>
<p>3:00 P.M. to 4:15 P.M.</p>	<p>6. MANAGING INFORMATION WHEN A CRISIS STRIKES</p> <p><i>When crisis strikes, events can quickly spin out of control. It is vital that municipal leaders be prepared to respond to media and citizen demands for information. This workshop is designed to assist you to communicate clearly and credibly during crises such as natural disasters, incidents of violence, and accidents involving hazardous materials. You will learn what steps your city can take to prepare for and respond to a crisis.</i></p> <p>Presiding: Mayor Kary Story, Pocahontas Speakers: Richard McKeown, Crisis Communication and Reputation Management Counselor</p>	<p>FULTON ROOM, SCC</p>
<p>3:00 P.M. to 4:15 P.M.</p>	<p>7. MANAGING YOUR PUBLIC WORKS DEPARTMENT</p> <p><i>Drainage control, pavement preservation, and traffic safety seem to be some of the biggest challenges of today's municipal public works departments. Today's speakers offer some ideas and suggestions.</i></p> <p>Presiding: Mayor Darrell Kirby, Bay Speakers: Sarah Tamayo, Engineer IV AHTD T² John Mathis, Asst. State Maintenance Engineer, AHTD T² Mark Earl, Staff Hydraulic Engineer AHTD T²</p>	<p>IZARD ROOM, SCC</p>
<p style="text-align: center;">*MH = Marriott Hotel *SCC = Statehouse Convention Center</p>		

4:15 P.M. to 4:30 P.M.	BREAK <i>Soft drinks and coffee available in the Exhibit Hall.</i>	GOVERNOR'S HALLS I - III, SCC
4:30 P.M. to 5:30 P.M.	RESOLUTIONS COMMITTEE <i>Each municipality has a designated representative who is a member of the Resolutions Committee.</i> Presiding: Mayor Doug Sprouse, Springdale First Vice President, Arkansas Municipal League	GOVERNOR'S HALLS IV, SCC
CONCURRENT WORKSHOPS		
4:30 P.M. to 5:30 P.M.	1. MUNICIPAL PARKS AND PLAYGROUNDS: ARE THEY SAFE AND IN COMPLIANCE WITH FEDERAL LAW? <i>When was the last time you conducted a parks and playground safety audit? This workshop covers the latest recommendations concerning playground safety.</i> Presiding: Alderman Reedie Ray, Jacksonville Speaker: Clint Pitzer, President ACS Playground Adventures	IZARD ROOM, SCC
4:30 P.M. to 5:30 P.M.	2. GRANTS AND FUNDING SOURCES <i>What is the latest information on State Aid Street funding? Are grants still available? If so how do you go about finding them?</i> Presiding: Alderman Steven Mays, Pine Bluff Speakers: Steve Napper, Attorney State Aid Street Committee Chad Gallagher, President Legacy Consulting Kevin Smith, Chairman and CEO The Grant Book Company	FULTON ROOM, SCC
*MH = Marriott Hotel *SCC = Statehouse Convention Center		

<p>4:30 P.M. to 5:30 P.M.</p>	<p>3. SOCIAL MEDIA SUCCESS: HOW CAN YOUR CITY BENEFIT?</p> <p>Social media is everywhere. Cities and towns can successfully engage citizens using various social media platforms with great success. Join us today and hear about the successes of cities and towns using social media. Also, pick up a few tips and tricks to better enhance your city's social media strategy.</p> <p>Presiding: Mayor Bill Edwards, Centerton Speakers: Matt Burks, Media Specialist Benton Police Department Recorder/Treasurer Nanette Barnes, Avoca Ben Cline, Communications Director Rogers Whitnee Bullerwell, Director of Communications Arkansas Municipal League</p>	<p>POPE ROOM, SCC</p>
<p>4:30 P.M. to 5:30 P.M.</p>	<p>4. ANIMAL CONTROL</p> <p><i>Establishing, maintaining and managing an animal control department is an ongoing challenge for municipalities. What can you do to adopt some best practices for your animal control department?</i></p> <p>Presiding: Alderman Dorothy Henderson, Warren Speaker: Edwin Creekmore, President Arkansas State Animal Control Association</p>	<p>CARAWAY ROOMS III, SCC</p>
<p>5:30 P.M.</p>	<p>The Exhibit Hall will close for the day.</p>	
<p>6:15 P.M. to 7:45 P.M.</p>	<p>DINNER AT THE GOVERNOR'S MANSION</p> <p><i>League members with reservations can board a bus to the Governor's Mansion starting at 5:45 p.m. at the Marriott.</i></p> <p>Transportation provided by Garver</p>	<p>ARKANSAS GOVERNOR'S MANSION</p>
<p>6:15 P.M. to 8:00 P.M.</p>	<p>DINNER ON YOUR OWN</p> <p><i>Visit some of central Arkansas's finest restaurants before returning for desserts and entertainment.</i></p>	
<p>8:00 P.M. to 10:00 P.M.</p>	<p>DESSERTS AND ENTERTAINMENT</p> <p><i>Drop by and enjoy a fantastic reception that includes desserts and entertainment. Music by Kemistri featuring Nicky Parrish will be a thrill for Convention attendees.</i></p> <p>Sponsored by:</p> <div style="display: flex; align-items: center;">  <div> <p>American Fidelity Assurance Company</p> </div> </div> <div style="margin-left: 20px;"> <p>American Fidelity Assurance Company Crews & Associates Simmons Bank Post Winery Veronica and Paul Post Little Rock Convention and Visitors Bureau</p> </div>	<p>WALLY ALLEN BALLROOM, SCC</p>
<p>*MH = Marriott Hotel *SCC = Statehouse Convention Center</p>		

<p>7:00 A.M. to NOON</p>	<p>REGISTRATION <i>(Be sure to download the League's meeting App onto your smart device. Search for "AML" in your App Store.)</i></p>	<p>OSAGE ROOM, SCC</p>
<p>7:00 A.M. to 10:30 A.M.</p>	<p>EXHIBITS OPEN <i>(Exhibit Hall will close at 10:30 a.m. for the remainder of the Convention.)</i></p>	<p>GOVERNOR'S HALLS I - III, SCC</p>
<p>7:00 A.M. to 8:45 A.M.</p>	<p>BUFFET BREAKFAST</p>	<p>GOVERNOR'S HALLS I - III, SCC</p>
<p>8:15 A.M.</p>	<p>CONTINUING LEGAL EDUCATION <i>City attorneys will receive 12 hours of CLE credit for participation in two days of meetings.</i></p>	<p>LEAGUE HEADQUARTERS</p>
<p>8:45 A.M. to 10:00 A.M.</p> 	<p>ANNUAL BUSINESS MEETING <i>At this session Executive Director Don Zimmerman will give his annual report followed by the Annual Business Meeting. During the business meeting, the League's Policies and Goals are presented and voted on. The nominating committee presents their recommended slate of new officers for the upcoming year, which will be followed by annual business meetings for the Municipal League Workers' Compensation Trust, Municipal Health Benefit Fund, Municipal Vehicle Program, and Municipal Property Program.</i></p> <p><i>(Be sure to download the League's meeting App onto your smart device. Search for "AML" in your App Store. You will need the App to access Business Meeting documents.)</i></p> <p>Presiding: Mayor Harry Brown, Stephens President Arkansas Municipal League</p>	<p>GOVERNOR'S HALL IV, SCC</p>
<p>10:00 A.M. to 10:15 A.M.</p>	<p>BREAK</p>	<p>GOVERNOR'S HALLS I - III, SCC</p>
<p>*MH = Marriott Hotel *SCC = Statehouse Convention Center</p>		

<p>10:15 A.M. to NOON</p>   	<p>GENERAL SESSION ECONOMIC AND BUSINESS DEVELOPMENT</p> <p><i>This session will feature invited speakers with special knowledge on Amendment 97. What was the legislative intent? How do you go about preparing for a project? What traps should you avoid? Speakers explain.</i></p> <p>Presiding: Mayor Doug Sprouse, Springdale First Vice President Arkansas Municipal League</p> <p>Speakers: Honorable Jim Hendren, State Senator District 2 J. Shepherd Russell, III, Attorney Friday, Eldredge & Clark Mark Hayes, Director of Legal Services Arkansas Municipal League</p>	<p>GRAND BALLROOM SALON C, MH</p>
<p>NOON to 1:30 P.M.</p>	<p>AWARDS AND NEW OFFICERS' LUNCHEON</p> <p><i>Municipalities and individuals are honored for their many successes and contributions during the past year. The new League president and officers will be introduced to the Convention delegates.</i></p> <p>Presiding: Mayor Harry Brown, Stephens President Arkansas Municipal League</p>	<p>GRAND BALLROOM SALONS A & B, MH</p>
<p>*MH = Marriott Hotel *SCC = Statehouse Convention Center</p>		

Post Banquet Reception

Stephens Inc.

111 Center Street
Little Rock, AR 72201
501-377-2000

Host City Breakfast

The City of Little Rock

500 West Markham, Room 203
Little Rock, AR 72201
501-371-4510

Wednesday's "Leadership" Speaker Jim Mathis

Raymond James

100 Morgan Keegan Dr., Ste 400
Little Rock, AR 72202
501-671-1323

Centennial Bank

2610 Cantrell Road
Little Rock, AR 72202
501-603-3849

Thursday's "No Barriers – Only Solutions" Speaker Neal Petersen

Mitchell Williams Law Firm

425 Capitol Avenue, Ste 1800
Little Rock, AR 72201
501-688-8848

Arvest Bank

4004 McCain Blvd.
North Little Rock, AR 72116
501-379-7337

Transportation to the Governor's Mansion Dinner

Garver

4701 Northshore Drive
North Little Rock, AR 72118
501-376-3633

Thursday Evening Reception

American Fidelity Assurance Company

P.O. Box 25523
Oklahoma City, OK 73125
405-523-5416

Simmons Bank

425 West Capitol Ave.
Little Rock, AR 72201

Post Winery

Veronica and Paul Post
1700 St. Mary's Mountain Road
Altus, AR 72821
479-468-2741

Crews & Associates, Inc.

521 President Clinton Ave.
Little Rock, AR 72201
501-907-2000

Little Rock Convention and Visitors Bureau

101 S. Spring Street
Little Rock, AR 72201

Friday Breakfast

AEP/Southwestern Electric Power Company

400 W. Capitol Ave., Suite 1610
Little Rock, AR 72201
501-376-0925

AT&T

1111 West Capitol, Room 1096
Little Rock, AR 72201
501-373 8084

eDocAmerica

11908 Kanis Road, Ste G-1
Little Rock, AR 72211
501-907-7117

Pettus Office Products

2 Freeway Drive
Little Rock, AR 72204
501-666-7226

tcprint Solutions

P.O. Box 15368
North Little Rock, AR 72231
501-945-7165

League Wellness Area

eDocAmerica

11908 Kanis Road, Ste G-1
Little Rock, AR 72211
501-907-7117

We value our loyal League Advertisers. Thank you.



SCOTT BEARDSLEY
sbeardsley@crewsfs.com
501.978.6385

PAUL PHILLIPS
pphillips@crewsfs.com
501.978.6309

NATHAN RUTLEDGE
nrutledge@crewsfs.com
501.978.7972

RAY BEARDSLEY
rbeardsley@crewsfs.com
501.978.6393

EDMOND HURST
ehurst@crewsfs.com
501.978.7941

BOB WRIGHT
rwright@crewsfs.com
479.927.4123

MARSHALL HUGHES
mhughes@crewsfs.com
501.978.7929

DAN LOVELADY
dlovelady@crewsfs.com
501.978.7958

GET MORE COMMUNITY FOR LESS CAPITAL.

At Crews & Associates, our public finance team is committed to enriching Arkansas communities. We create custom financing solutions to improve utilities and municipal resources for residents – and save money for communities. Contact us today and see what Crews can do for you.



800.766.2000 • crewsfs.com
BONDS | LEASES | LOANS

crewsfs.com
Member FINRA & SIPC

We value our loyal League Advertisers. Thank you.

A LEGACY OF STRENGTH FOR A FUTURE OF PROSPERITY



At Stephens, our commitment to public finance dates to our founding in 1933. In the years since, we have remained true to our core belief that financial strength, superior execution and relationships built on trust are the pillars of Stephens Public Finance. These pillars will continue to inspire us as we work together with municipal officials across the State to help build the infrastructure that creates better communities for all of our citizens.

Little Rock 800-643-9691
Fayetteville 800-205-8613

LITTLE ROCK, AR • ATLANTA, GA • BATON ROUGE, LA
CHARLOTTE, NC • DALLAS, TX • FAYETTEVILLE, AR
JACKSON, MS • NASHVILLE, TN

Stephens
Public Finance

STEPHENS INC. • MEMBER NYSE, SIPC

 @Stephens_Inc

STEPHENSPUBLICFINANCE.COM

ADVERTISERS

We value our loyal League Advertisers. Thank you.



ARKANSAS MUNICIPAL EQUIPMENT

ametrucks.com

501-425-1567

Daniel Ellison

PROVIDING QUALITY REFUSE AND RECYCLING EQUIPMENT TO MUNICIPALITIES.



ADVERTISERS

The only Top 10 public
finance firm in Arkansas also
has some of the deepest roots.



CHAD MYERS // MARY MORGAN GLADNEY // SAMANTHA WINEKE // DANIEL ALLEN
RON PYLE // SAM NAGEL // PATRICIA QUINN // JIM BIRDWELL
GAVIN MURREY // CARMEN QUINN // CHUCK ELLINGSWORTH // ELIZABETH ZUELKE

Our team has a long history of serving the Arkansas public sector we can trace back to 1931, when T.J. Raney & Sons opened its doors. A history that continued when we became Morgan Keegan and then joined forces with Raymond James. And through all that time, our commitment to our clients and to the communities across our state has only grown, helping us become one of the top 10 underwriters in the country – and the only top 10 national firm in Arkansas.

Put our unique combination of local history and national strength to work for you.
Visit rjpublicfinance.com.

ARKANSAS PUBLIC FINANCE

100 Morgan Keegan Drive, Suite 400 // Little Rock, AR 72202 // 501.671.1339

RAYMOND JAMES®

According to Thomson Reuters. Past performance is not indicative of future results.
©2015 Raymond James & Associates, Inc., member New York Stock Exchange/SIPC. 15-PF-0251 JD/EK 6/15

Between these lines you'll discover experienced attorneys providing

TRUSTED

business, regulatory and litigation services. Working as strategic legal

ADVISORS

Mitchell Williams plays a critical role

IN

providing the legal counsel and strategic support municipalities, authorities and special units of local government need today. Our broad experience helps us meet

YOUR

specific concerns, with customized solutions for organizations in every

CORNER

of Arkansas and beyond. Serving you is right where our team wants to be.

Nationally Recognized Practices.

Nationally Recognized Lawyers.

MitchellWilliamsLaw.com

MITCHELL || WILLIAMS

Jonesboro | Little Rock | Rogers | Austin
Mitchell, Williams, Selig, Gates & Woodyard, P.L.L.C.

425 W. Capitol Ave., Suite 1800 | Little Rock, AR 72201 | 501-688-8800 R.T. Beard, III, Managing Director

Thinking about **annexation**
for **population**?

City

County

Get it **done** before the end
of **2018**.

ANNEXATION MAPPING ACA 14-40-101

**ARKANSAS
GIS OFFICE**

aglo.all@arkansas.gov
gis.arkansas.gov
(501) 682-2767



ADVERTISERS



ETC Engineers & Architects, Inc.

1510 S. Broadway, Little Rock, AR 72202
Phone (501) 375-1786
www.etcengineersinc.com

Architecture, Public Buildings
Parks Planning and Design
Stormwater, Hydraulic Modeling
Water & Wastewater Systems
Street and Drainage Designs
Aquatic Parks



ADVERTISERS

Henard Utility Products

Authorized Distributor of Badger Meter

www.henardutility.com

800-776-5990

Badger Meter



Clearly Better.

Specializing in Water Meter Data Collection/Management

- Cellular fixed based transmitters
- Hosted and managed analytical software
- Flexibility to keep you in step with technology advancements
- Data tools provide greater water usage visibility to your city and your customers

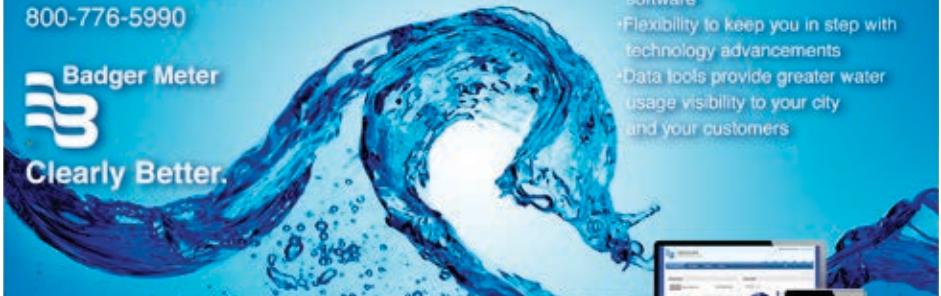

BEACON

Advanced Metering Analytics





WEALTH MANAGEMENT | ARVEST

CHARTING YOUR RETIREMENT LIFESTYLE

At Arvest, we have an experienced Wealth Management Team focused entirely on your personal wealth management strategies. From investments and insurance to retirement planning and trusts, we're thinking about you and your future. Together, we can make your future stronger. Talk to one of our financial professionals for a free, objective review of your current trust, insurance or investments.

Don't navigate this adventure alone, let us be your guide.
Visit arvest.com/wealth, an Arvest near you or call us at (501) 379-7337.

Investment products and services provided by Arvest Investments, Inc., doing business as Arvest Wealth Management, member FINRA/SIPC, an SEC registered investment adviser and a subsidiary of Arvest Bank. Insurance products made available through Arvest Insurance, Inc., which is registered as an insurance agency. Insurance products are marketed through Arvest Insurance, Inc. but are underwritten by unaffiliated insurance companies. Trust services provided by Arvest Bank.

Investments and Insurance Products: Not a Deposit | Not Guaranteed by the Bank or its Affiliates
Not FDIC Insured | Not Insured by Any Federal Government Agency | May Go Down in Value



Don't miss out!
AML is providing this service at a discounted rate for all members. Contact your account manager today to learn more.

SB-29354-1013

- easily track employee work hours
- manage benefits eligibility
- comply with emerging regulations
- avoid costly free rider penalties

With all you do, let us take care of you.

American Fidelity Assurance Company (American Fidelity) is pleased to partner with Five Points to assist AML members with their Patient Protection and Affordable Care Act (ACA) tracking and reporting through a proprietary technology platform called MyBenefitsChannel.com.

From monitoring employee hours in real time to calculating whether variable hour employees will be considered full-time under the law, we are here to help.

Some of our products and services may be provided by third party contractors or affiliated companies.

Charles Angel
Senior Account Executive
800-654-8489, ext. 3132

americanfidelity.com

AMERICAN FIDELITY
a different opinion

ADVERTISERS

Does Payroll Got Your Office Tied Down? *Let Our Experts Handle it!*



DirectPay
Payroll Solutions®

Call Us Today! 800-451-2288
www.directpayrollonline.com

Simplify Your Payroll Process

Our friendly staff is ready to take the hassle out of your payroll and tax preparation, saving you time and money. We'll help you trim administrative costs by freeing up staff time and establishing better efficiency in operations.

FREE SET-UP

AFFORDABLE RATES

Some Of Our Features

- > Access to our Web App for Employee Tracking & HR Reporting.
- > We Process Payroll
- > We cut Payroll Checks, Garnishments, offer Direct Deposit, and Pay Cards
- > Place your Payroll Taxes Online
- > Process Quarterly 941's, 940's & w-2's

ADVERTISERS



McGoodwin Williams & Yates Engineering Confidence

Con-fi-dence: noun /'kän-fə-dəns/

1. Consciousness of one's abilities.
2. Faith that one will act in a right, proper, or effective way.
3. The quality of being certain.
4. A relation of trust.



MWY has entered its 70th year of providing innovative solutions to municipalities across our region. MWY is your trusted answer, bringing fresh perspectives tempered by our firm's decades of hands-on experience.

At MWY we are *engineering confidence for a better tomorrow.*

302 East Millsap Road, Fayetteville, AR 72703 | Phone: 479.443.3404 | Fax: 479.443.4340

- CITIES OF DISTINCTION HAS BECOME -



ARKANSAS BUSINESS
TRENDSETTER CITY
2017

PRESENTED BY



IN PARTNERSHIP WITH



Purpose To recognize cities/towns of all sizes from around the state who are leaders in innovative programs for improvement and growth. Being a Trendsetter City speaks to the commitment by city leadership and its citizens, and creates a great economic development selling point.

Winners will be recognized in the following categories

- Public Safety
- Infrastructure/Utilities/Water
- Education/Workforce Development
- Wellness and Fitness
- Tourism Development/Creative Culture
- Environmental/Green Management Practices

Three Population Categories to compete in:
Under 5,000 // Between 5,000 and 20,000 // More than 20,000



TO ENTER, GO TO
arkansasbusiness.com/trendsetter

For more information contact Bonnie Jacoby at Bonnie@abpg.com or (501) 372-1443

NOW ENTERING: RECREATION AND RELAXATION.
Parks • Athletic Facilities • Swimming Pools

Great Cities Make a Great State.

arkansas municipal league
great cities make a great state
greatcitiesgreatstate.com

ADVERTISERS



HELPING
YOUR
TOWN PUT
MAIN STREET
BACK
ON THE
MAP

main street revitalization
downtown little rock



Crafton Tull

engineering | architecture | surveying | planning
www.craftontull.com

THE INDUSTRY'S BEST WOOD
PROCESSING EQUIPMENT...

NOW AVAILABLE
IN YOUR
BACKYARD.

Bandit offers wood processing equipment for any size project, from chippers and stump grinders to horizontal grinders and more.

Offering Chippers, Grinders,
Parts, Service & More!

Call your local Bandit dealer today!

SEE OUR COMPLETE LINE OF PRODUCTS IN ACTION!

www.youtube.com/banditchippers



Bandit
INDUSTRIES, INC.

Now Serving Arkansas
Henard Utility Products • Searcy, AR
Phone: 800.776.5990
Web: www.henardutility.com

IT in a Box
A complete IT solution for city governments.

New City Website
Modern fresh design. We manage the content. Accept online payments.

Data Backup
Unlimited office data backup storage for disaster recovery. Real-time monitoring. Quarterly testing.

Document Management
Protect city records. Apply record retention schedules.

Email
Separate personal and city addresses. Share calendars. Includes Microsoft Office Professional Plus.

Open Records Requests
Be prepared for FOIA and Open Records Requests. We will help the clerk process them.

Vendor Management
No more frustrating calls with vendors. We got it.

Server Desktop & Mobile Management
Guard against cyber risks. Keep your computers patched, protected, and healthy.

Who guarantees IT services based on your expectations?

WE DO!

Certified
Experienced certified senior engineers. We are DUC certified.

Helpdesk
24x7. We are always there when you need help.

Our GUARANTEE

Love IT. We don't meet your expectations, cancel the service!	Flat monthly fee. No hourly charges. Predictable!	Flexible. Flexibility in duration (subscription monthly)
Easy out. 30 days notice!	No upfront project fees. Donating, equipment, and setup included!	Proven. Tailored for cities.

Sales: 779.679.6840 x128
info@suphicity.com
www.suphicity.com

Powered by **Sophicity**

Chris Hartley
503.978.4206
chhartley@amf.org
www.amf.org



GarverUSA.com

Broadway Bridge
Pulaski County, Arkansas



We work here. We live here.

**We're invested
in Arkansas.**

For more information, contact:
Jerry D. Holder, PE | Director of Transportation
JDHolder@GarverUSA.com | 501.376.3633

We're here to get your project off the ground.

Regardless of the size or scope of your needs, McClelland Consulting Engineers, Inc. has the experience and expertise to see your project through to completion. We commit our time, our energy and our professionalism to ensure all projects enhance the quality of life, improve infrastructure and offer positive economic impact in each community in which we work.

MCE is designed to serve!





MCE McCLELLAND
DESIGNED TO SERVE CONSULTING
ENGINEERS, INC.
mcclelland-engrs.com
501.371.0272

110 South 7th Street
Van Buren, AR 72956
479.474.1227

211 Natural Resources Dr.
Little Rock, AR 72205
501.374.4866

Because At Times It Needs to Flow Uphill



HW
HAWKINS-WEIR
Engineering
Client Success
www.hawkins-weir.com
www.facebook.com/HWEngineers



READY TO BUILD?
We can help with that.

We work closely with prospective building owners and developers to create a seamless construction process—from concept, land acquisition, and the selection of architects and contractors; negotiating and overseeing contracts; and acting as a liaison with the architect and contractor throughout the building process, all the way to completion.

Our experience in every aspect of construction makes us an invaluable advisor on your next project.

BCC
BROWNLEE
Construction Consultants, LLC

501-666-9401
porter@bcc-ar.com
www.bcc-ar.com

Are Your Bad Debt Accounts Adding Up?

Having No Success With Collection Agencies...

Turn Those Bad Debts Into Deposits By Joining The Water Utility DataBase System

WUDB SYSTEM®

A network of Municipalities and Rural Water/Sewer systems across the state, through legislation have joined forces through our database system to track and collect their otherwise uncollectable bad debts.

Won't You Join Them By Joining WUDB Today...

For more information contact an ARWA representative, contact us at 800-264-0303 or go to www.wudb.com

ADVERTISERS

We value our loyal League Advertisers. Thank you.



We're in Your Corner.

The features you need, the service you deserve.

Distributed by

CSAsoftwaresolutions
Accounting & Billing Specialists

www.cssoftwaresolutions.com • 800.264.4465



CenterPoint® Fund Accounting
and Payroll Software

Foster Motor Company

316 Thomas Road
White Hall AR 71602
870-247-2670
1530@ exit 36



Joel or Noel Foster
870-540-7918
Commercial Truck
Sales and Service

Rescue Kodiak Truck with water \$29,500
low miles



2007 CCC Refuse Sideload, \$69,000



Rescue Pumper \$39,500
Pump tested, department ready.



2002 Fire Engine \$59,000, pump tested
Nice



2011 International Tracker, \$39,900



Chevrolet Pro-Patch Truck, \$19,500



ADVERTISERS

CSAsoftwaresolutions
Accounting & Billing Specialists

CenterPoint®

Fund Accounting & Payroll

Key Features

- Direct Deposit Module
- Accrue and track vacation/sick leave
- Unlimited funds, departments & accounts
- Detailed general ledger and activity report
- Easy bank reconciliation
- Produce annual published report
- Drill-down to detail of transaction
- Print income statements with budgets
- Receive on-site installation and training

Call us today for a
free information packet!

1.800.264.4465

WWW.CSASoftwareSolutions.com

Occupational CPR/First Aid Training LLC

Get your certification the same day as your training.

Instructors with considerable training and experience in first response can train and certify your employees at your workplace.

- Adult First Aid, CPR, AED
- Pediatric First Aid, CPR, AED
- Basic Life Support Training
- Meets Arkansas DHS requirements
- Certification is good for 2 years

All courses comply with the 2015 Emergency Cardiovascular Care and the American Heart Association

Edwin E. Waddell
(501) 425-6163
edwinehazel@gmail.com

Troy D. Tate
(870) 403-4847
tdtate38@gmail.com



96.89
PERCENT
OF ARKANSAS'S

POPULATION GROWTH

— OCCURRED WITHIN —
THE CITY LIMITS.

www.greatcitiesgreatstate.com

Exhibitors, be sure to download the League's meeting App onto your smart device. Search for "AML" in your App Store.

Ace Sign Company

11935-I30
Little Rock, AR, 72209
501-562-0800
FAX: 501-492-8268
www.acesigns.com

Ace Sign Company is a nationwide manufacturer of all types of signage ranging from channel letter, hole signs, and electronic display signs.

ACS Playground

8500 Mantle
Oklahoma City, OK, 73132
405-721-3506
FAX: 405-721-3514
www.acsplay.com

Providers of playgrounds, splashpads, shade structures, and other recreational products.

Arkansas Commissioner of State Lands

500 Woodlane Street, Suite 109
Little Rock, AR, 72201
501-683-3031
FAX: 501-682-1996
www.cosl.org

Commissioner of State Lands is a state agency and constitutional office. The commissioner of state lands (or land commissioner) is one of seven constitutional officers serving the state of Arkansas. Primarily, the land commissioner oversees the disposition of tax-delinquent property, but the office is also responsible for certain historic preservation initiatives and the leasing of natural resources on state-owned lands.

Arkansas Drone Solutions

82 Johnson Loop Road
Greenbrier, AR, 72058
501-690-6822
FAX: 501-679-2370
www.ar dronesolutions.com

Arkansas Drone Solutions provides drone/UAV sales, setup, delivery, support, and training. We feature DJI products including the Mavic Pro, Phantom Series, Inspire Series and the new Matrice 200 Series.

Arkansas Economic Development Commission

900 W Capitol Avenue, Suite 400
Little Rock, AR, 72201
501-682-7325
FAX: 501-682-7394
www.arkansasedc.com

We create economic opportunity by attracting higher paying jobs, expanding and diversifying our state and local economies, increasing incomes and investment, and generating positive growth throughout Arkansas. Arkansas is a pro-business environment operating leaner, faster and more focused through a streamlined state government designed to act on corporate interests quickly and decisively.

American Fidelity Assurance Company

9000 Cameron Parkway
Oklahoma City, OK, 73114
405-523-5416
FAX: 405-523-5425
www.americanfidelity.com

When protecting your employees with supplemental benefits, it's best to partner with someone who has expertise in your industry. American Fidelity is a different opinion.

Arkansas GIS Office

1 Capitol Mall, Suite 6D
Little Rock, AR, 72201
501-682-2767
FAX: 501-407-0790
www.gis.arkansas.gov

The Arkansas Geographic Information Systems (GIS) Office promotes the efficient development, maintenance, and distribution of Arkansas's geographic information resources. The GIS Office is the state's single point of contact for the U.S. Census Bureau's Boundary and Annexation Survey (BAS) and is therefore responsible for providing accurate and up to date municipal boundaries to be used with each decennial census.

Arkansas Holiday Lighting

P.O. Box 17878
North Little Rock, AR, 72117
501-978-2899
FAX: 501-375-8931
www.buzzfreearkansas.com

Arkansas Holiday Lighting specializes in commercial lighting. We handle large light displays along with your normal string lights. We can custom make your Christmas decorations or any holiday decorations.

Arkansas Natural Resources Commission

101 East Capitol, Suite 350
Little Rock, AR, 72201
501-682-0547
FAX: 501-682-0561
www.ANRC.arkansas.gov

ANRC Water Resources Development provides financing options for water and wastewater systems as well as solid waste projects.

Arkansas One-Call

2120 Maple Ridge Circle
Conway, AR, 72034
501-328-2500
FAX: 501-328-2522
www.arkonecall.com

Arkansas One-Call is a statewide call-before-you-dig center and we have information about damage prevention.

Arkansas Public Administration Consortium

Ross Hall 625, 2801 South University
Little Rock, AR, 72204
501-569-3090

The Arkansas Public Administration Consortium is dedicated to improving the quality of public services in Arkansas through public administration education and management training opportunities for public and nonprofit organizations. The Certified Public Manager (CPM) program is a nationally accredited, comprehensive management-developed program specifically for managers in state and local government and nonprofits.

Arkansas Rural Water Association

P.O. Box 860
Lonoke, AR, 72086
501-206-8200
FAX: 501-676-2266
www.arkansasruralwater.org

We provide free technical assistance and training for public water and wastewater systems.

Arkansas State Animal Control Association

P.O. Box 138
Lavaca, AR, 72941
479-769-5238
FAX: 479-784-1595
www.arkansasanimalcontrol.com

Since 1986 ASACA has been in operation to assist animal control officers, their cities, counties, and government. We strive to provide updated information and train animal control officers to have the knowledge to perform their duties to the best of their ability.

Arkansas State Treasurer

500 Woodland Avenue, Suite 220
Little Rock, AR, 72201
501-682-1423
FAX: 501-682-3820
www.artreasury.gov

Sponsored by the State of Arkansas, the AR 529 Gift College Investing Plan is a great investment for tomorrow, allowing your college savings to grow tax-deferred in a wide variety of investment options.

Arkansas Tax Associates, Inc

2908 King Street
Jonesboro, AR, 72401
870-802-2600
FAX: 870-802-2727
www.arktax.com

Arkansas Tax Associates, Inc. is a full-service sales and use tax consulting agency. We provide in-depth review of sales and use tax practices of municipalities, and universities. Work is completed by former auditors with the Arkansas Department of Finance, and is on a contingency basis. There have been 52 governmental agencies take advantage of our expertise with a recovery of over \$3.8 million in overpaid tax.

Arvest Wealth Management

4004 McCain Blvd.
North Little Rock, AR, 72116
501-379-7337
FAX: 501-379-7237
www.arvest.com

Arvest Wealth Management offers clients the resources they need to build, manage, and protect their wealth. Our areas of expertise include retirement planning, saving for education costs, insurance, trusts, and estates.

AT&T

1111 West Capitol, Rom 1096
Little Rock, AR, 72201
501-373-8084
FAX: 501-373-3090
www.att.com

AT&T Inc. (NYSE:T) helps millions around the globe connect with leading entertainment, business, mobile and high-speed Internet services. We offer the nation's best data network and the best global coverage of any U.S. wireless provider. We're one of the world's largest providers of pay TV. We have TV customers in the U.S. and 11 Latin American countries.

Auditor of State

500 Woodlane Avenue, Suite 230
Little Rock, AR, 72201
501-681-7480
www.auditor.ar.gov

Stop by Auditor of State Andrea Lea's booth to search for treasure in the Great Arkansas Treasure Hunt. One in four Arkansans has something to claim.

Bradford Health Services

4 Executive Center Court
Little Rock, AR, 72211
501-725-8008
FAX: 501-725-8009
www.bradfordhealth.com

Bradford Health has been around for over 30 years helping professionals, individuals, and families recover from substance abuse. Our entire continuum of care allows us to meet the patient where they are in life to address a life changing disease.

Carrothers Construction Co., LLC

401 West Wea
Paola, KS, 66071
913-294-8120
FAX: 913-294-5459
www.carrothersconstruction.com

Carrothers provides construction management and design build services for municipal aquatic centers and swimming pools. Services include planning, design, budgeting, and construction.

CEI Engineering Assoc., Inc.

3108 SW Regency Parkway, Suite 2
Bentonville, AR, 72212
479-273-9472
FAX: 479-273-0844
www.ceieng.com

CEI is a full-service civil engineering, planning, landscape architecture, and land surveying consulting firm established in Bentonville in 1973. We proudly offer services to cities in Arkansas that include public works, transportation, parks and recreation, trails, and playground design.

Clarke

675 Sidwell Court
Saint Charles, IL, 60174
800-323-5727
FAX: 630-443-3070
www.clarke.com

Clarke is an environmental products and services company specializing in mosquito control and aquatic services.

Crews & Associates, Inc.

521 President Clinton Avenue,
Suite 800
Little Rock, AR, 72201
501-978-7953
FAX: 501-907-4015
www.crewsfs.com

Crews & Associates is a full-service investment banking firm headquartered in Little Rock, specializing in the origination and distribution of fixed income products including tax-exempt bonds, capital leases, and other credit facilities for our governmental clients in Arkansas and nationally. Crews is a wholly-owned subsidiary of First Security and has underwritten more than \$84 billion in financing.

Crown Technology, Inc.

35 Industrial Park Drive
Woodbury, GA, 30293
706-553-9500
FAX: 706-553-3958
www.crownthermo.com

A high-performance, thermoplastic pavement marking manufacturer, Crown Technology's preformed thermoplastic is a no-preheat, easy to install, durable pavement marking system. Available in a variety of colors and mil thicknesses, Tuff-Mark™ preformed thermoplastic is designed to last 8 to 10 times longer than similar painted traffic markings. Add Tuff-Grip™ to any Tuff-Mark™ symbol or legend for optimum skid resistance and retro reflectivity.

CSA Software

9900 Maumelle Blvd.
Maumelle, AR, 72113
501-801-9900
FAX: 501-801-3573
www.csasoftwaresolutions.com

Since 1983, CSA Software Solutions has partnered with small to medium sized cities and utility companies to provide our clients with incredible software that meets their fund accounting and utility billing needs. While providing exceptional support that allows them to effectively serve their communities.

**Cunningham Recreation/
GameTime**

P.O. Box 240981
Charlotte, NC, 28224
800-438-2780
FAX: 704-525-7356
www.cunninghamrec.com

Since 1966, Cunningham Recreation has been providing customers with safe, affordable park and playground equipment, a variety of safety surfacing materials, sports and fitness equipment, shade and shelters, site furnishings, water play, skate parks, and dog parks from design to construction. We also offer playground inspection services and inspection software.

**Custom Pavement
Maintenance & Safety, LLC**

P.O. Box 435
Van Buren, AR, 74957
479-262-6160
FAX: 479-235-2046
www.custompavement.com

Pavement markings, maintenance, guardrail, traffic items, signage, rejuvenator, sealcoat, crackseal, friction testing, airport markings, markings removal, preformed thermoplastic.

DatabaseUSAgov.com

11211 John Galt Blvd.
Omaha, NE, 68137
402-939-3895
FAX: 402-255-9099
www.databaseUSAgov.com

DatabaseUSAgov.com compiles and transforms big data to create databases of businesses and consumers in the U.S. for information solutions used by federal, state and local governments for research, mapping, tax, and emergency services. The DatabaseUSAgov.com databases can be searched and filtered to provide any subset of the information based on geography and demographic filters.

DataMax

7400 Kanis Road
Little Rock, AR, 72204
501-603-3040
FAX: 501-603-3002
www.datamaxarkansas.com

We provide office equipment, managed IT services, document imaging storage and retrieval. We are a Microsoft Gold Partner, We also have Dell computers, Canon, Konica, Minolta and Lexmark.

Datek, Inc.

4007 Richards Road
North Little Rock, AR, 72117
501-945-0907
FAX: 501-945-7472
www.datekcorp.com

Datek is a supplier and consultant in the office supply, cleaning and maintenance industry. We have been providing high quality products to customers since 1976, and look forward to servicing you. We offer sales and on-site service for the entire region, Arkansas, West Tennessee, North Mississippi, Eastern Oklahoma, and Southwest Missouri.

David's Fire Equipment

8783 John Harden Drive
Cabot, AR, 72023
501-941-3313
FAX: 501-941-3315
www.davidsfire.com

David's Fire Equipment stocks a complete line of firefighting equipment and other equipment needed for public services like: flashlights, safety vests, rain gear, amber warning lights, scene lighting, and may other items. David's sells Reliable Fire Trucks manufactured in Cabot, Arkansas.

Davis Playgrounds Inc.

104 Orchid Drive
Maumelle, AR, 72113
501-851-0756
FAX: 501-851-4130
www.davisplaygrounds.com

Commercial playground equipment and supplies. Shades, surfacing, pavilions, design and installation.

Department of Information Systems

1 Capitol Mall, 3rd Floor
Little Rock, AR, 72203
501-683-4950
FAX: 501-682-4010
www.dis.arkansas.gov

The Department of Information Systems is an information technology solution provider for the State of Arkansas. As IT professionals, we provide services from telephone and data networking to technical consulting.

eDocAmerica

11908 Kanis Road, Suite G-1
Little Rock, AR, 72211
501-907-7117
FAX: 501-907-7118
www.edocamerica.com

In 1999, eDocAmerica was formed and became a pioneer in telemedicine. We are known for providing first level telemedicine services that provide online access to medical professionals including physicians, psychologists, pharmacists, dentists, dietitians, fitness trainers, and other physician specialties. With eDocAmerica, users can ask whatever they want, whenever they want, and always get a personal response.

EFS GeoTechnologies

360 Airport Road
Monticello, AR, 71655
870-460-9994
FAX: 870-460-9996
www.efsgeotech.com

EFS GeoTechnologies is based in Monticello, Arkansas, and provides high resolution digital aerial imagery and GIS services. EFS offers a wide range of mapping solutions customized for Arkansas cities including a One Map system, 'EDGE.' EDGE is currently being used for infrastructure, nuisance properties, permitting, etc.

Engineering Services, Inc.

P.O. Box 282
Springdale, AR, 72765
479-751-8733
FAX: 479-751-8746
www.engineeringservices.com

Consulting engineers and surveyors providing services to municipal clients for water and wastewater, street and storm drainage, parks, trails, land development, mapping, and master planning projects.

Employer Support of the Guard and Reserve

Camp Robinson - Box 27
North Little Rock, AR, 72199
501-212-4018
FAX: 501-212-4058
www.esgr.mil

Employer Support of the Guard and Reserve (ESGR) is a Department of Defense agency that seeks to create a culture in which all American employers support and value the military service of their employees. We recognize outstanding employer support, increase awareness of the USERRA Law, assist service members in obtaining employment, and resolve employee/employer conflicts as it relates to military service through mediation. www.facebook.com/arkansas.esgr

ETC Engineers & Architects

1510 South Broadway
Little Rock, AR, 72202
501-375-1786
FAX: 501-375-1277
www.etcengineersinc.com

ETC Engineers & Architects offers architectural and engineering services for municipalities.

EZ Street Cold Asphalt

1653 Batesville Blvd.
Batesville, AR, 72501
870-251-2371
FAX: 870-251-2371
www.atlasasphaltinc.com

Producer of cold asphalt for pothole, utility cuts, manhole, and valve cover repairs. Manufactured in Batesville and Jonesboro, Arkansas.

Ferrara Fire Apparatus

P.O. Box 249
Holden, LA, 70744
225-567-7100
FAX: 225-567-7765
www.ferrarafire.com

Fire truck manufacturer for custom or commercial fire trucks and large equipment sales.

First Step Pavement Management

4772 West Plymouth Rock Place
Fayetteville, AR, 72704
479-422-7687
www.greenbergfarrow.com

Founded in 1974, GreenbergFarrow is a fully integrated landscape architecture, pavement management, engineering, planning, architecture and development services firm offering a comprehensive range of services to public and private sector clients.

Foundation Pro

1500 Locust
North Little Rock, AR, 72114
501-753-1009
FAX: 501-753-2780
www.foundationproar.com

We are a central Arkansas based structural foundation repair company that addresses both interior and exterior issues. Since 1996, Foundation Pro has specialized in residential and commercial repair.

FTN Assoc., Ltd

3 Innwood Circle, Suite 220
Little Rock, AR, 72211
501-225-7779
FAX: 501-225-6738
www.ftn-assoc.com

FTN is an engineering and environmental consulting firm that has a great deal of experience working with municipalities throughout the state. Our headquarters is in Little Rock and we have a large branch office in Fayetteville. We have more than 70 employees and have been in business for more than 35 years.

Garver

4701 Northshore Drive
North Little Rock, AR, 72118
501-376-3633
FAX: 501-537-3407
www.GarverUSA.com

Garver is an employee-owned multi-disciplined engineering, planning, architectural, and environmental services firm, headquartered in North Little Rock, Arkansas. With over 400 employees spread between 22 offices in 10 states, Garver offers an array of services with a focus on aviation, construction, facilities design, federal, power, transportation, survey, and water products.

Globe Life Insurance

3700 South Stonbridge Drive
McKinney, TX, 75070
214-733-9226
FAX: 972-569-3216
www.esdglobe.com

Globe Life and Accident Insurance Company offers supplemental life and health insurance products.

GovDeals, Inc.

100 Capitol Commerce Blvd.,
Suite 110
Montgomery, AL, 36117
800-613-0156
FAX: 334-387-0519
www.GovDeals.com

GovDeals.com is the leading provider in online government surplus auctions. All state and local governments are welcome to use our services to auction surplus in the smartest, most efficient way possible.

Govpay Network

13818 SW 152 Street, Suite 136
Miami, FL, 33177
866-893-9678
FAX: 877-370-6953
www.govpaynetwork.com

Govpay Network is aware of the different challenges faced by government employees. Using our own experience as former civil servants, coupled with serving this industry for the last four years, we have devised a technologically advanced payment processing system designed specifically to your needs, and which helps you to proceed with your payment processing in a convenient, secure, and cost-free manner. By doing this we can lessen the payment processing burden on your clerk thus allowing for better collections and more productivity from your staff.

Grasshopper Company

P.O. Box 637
Moundridge, KS, 67107
620-345-8621
FAX: 620-345-2301
www.grasshoppermower.com

Grasshopper True ZeroTurn radius riding rotary mowers and QuikConverter attachment system for year-round implements.

Green Environmental Services

P.O. Box 428
Beebe, AR, 72012
501-288-8346
FAX: 501-804-9520
www.yourges.com

We are a full-service solid waste pick-up, transportation, and disposal company providing residential, commercial, and industrial services.

Guard4Life

106 Ridgeway
Hot Springs, AR, 71901
501-762-6745
www.g4ltracking.com

Guard 4 Life is a company devoted to providing efficient GPS tracking solutions for consumers and entrepreneurs all over the U.S. Our software and tracking devices are implemented with cutting-edge technology.

Halff Associates

10411 West Markham, Suite 320
Little Rock, AR, 72205
501-837-5640
www.halff.com

We are a unique regional consulting firm that has provided full-service engineering, architecture, and related services for decades. Our staff of more than 650 includes engineers, architects, planners, scientists, and surveyors. We believe in developing innovative solutions to serve our clients, while addressing infrastructure concerns related to mobility, water transmission and distribution, wastewater collection, as well as drainage and flood management.

Henard Utility Products, Inc.

P.O. Box 9238
Searcy, AR, 72145
501-268-1987
FAX: 501-268-7437
www.henardutility.com

Dealer/distributor for municipal and utility equipment, including water meters, brush chippers and wood recyclers, street sweepers, knuckleboom loader trucks, leaf vacuums, tractors, backhoes, excavators, track and skid steer loaders, sewer cleaning equipment, and sewer TV systems.

Holophane Lighting

4121 Hartford Hills Drive
Benton, AR, 72019
501-920-0051
FAX: 866-720-3559
www.holophane.com

Holophane manufactures lighting fixtures, lighting poles, and lighting controls.

J&R Equipment

508 Autumnwood Drive
Russellville, AR, 72802
479-445-8896
FAX: 405-495-5112
www.jandreqipment.com

While technology has dramatically changed since the early days, the need for equipment solutions hasn't. J & R and Sanson Equipment are committed to providing sales and service for Arkansas. We offer a full line of refuse equipment and sewer cameras for our customers.

Johanson Group/DBSquared

2928 McKee Circle, Suite 123
Fayetteville, AR, 72703
479-521-2697
FAX: 479-521-5453
www.johansongroup.net
www.dbsquared.com

Fayetteville, Arkansas, based management/HR consulting firm that specializes in compensation management/software and other HR related services, including employee handbook, training and development, recruitment, and psychological testing.

Keycity Mfg.

5418 Marion Avenue
Chattanooga, TN, 37412
888-673-1111
FAX: 888-673-1111
www.keycity.com

Manufacturers and distributors of custom-made "Keys to the City," lapel pins, coins, and other promotional merchandise for municipalities. We have many customers in Arkansas. Come by our booth for a free Razorbacks pin. We will have a display of the merchandise we make and sell.

Kyle Recreation

6834 Cantrell Road, Suite 28
Little Rock, AR, 72207
501-227-6125
FAX: 501-227-6124
www.kylerecreation.com

Kyle Recreation represents cutting-edge companies such as LITTLE TIKES COMMERCIAL playground equipment, POLYGON steel, wood, and fabric pavilions, gazebos and amphitheaters USASHADE fabric shades, BRP site furnishings and Bison equipment, NOFAULT Surfacing, ZEAGER WoodCarpet surfacing, to name a few. We can provide design and complete turnkey installation for your playground or pavilion.

Landmark Engineering & Surveying

13311 Lawson Road
Little Rock, AR, 72210
501-224-1000
FAX: 501-227-7200

Landmark Engineering & Surveying is an engineering design and surveying service with civil engineers and land surveyors.

Larkin Aquatics

9001 State Line Road, Suite 200
Kansas City, MO, 64114
816-361-0440
FAX: 816-361-0045
www.larkinaquatics.com

Larkin Aquatics has specialized in the planning and design of municipal recreation and aquatic facilities across the U.S. since 1948. We are experienced in all facets of aquatic design: water and chemical treatment, structures, hydraulics, filtration, coatings, piping, pumps, geotechnical concerns, lighting, concrete, and electrical design.

Legacy Consulting

523 South Louisiana, Suite 222
Little Rock, AR, 72201
501-246-8842
FAX: 501-935-6893
www.legacyincorporated.com

Our services to the small cities and towns include site visits to the communities, evaluations, and suggestions for improvements in the areas of community and economic development. In addition, we provide assistance in the search for and implementation of grant opportunities that can greatly enhance their communities.

Long Sales Agency

914 Barber Street
Little Rock, AR, 72202
501-374-3088
FAX: 501-374-8459
www.longsalesagency.com

Lighting and controls manufacturers' representatives. Downtown projects, sports lighting, park and recreation projects. Application in residential, commercial, and industrial.

McClelland Consulting Engineers, Inc.

7302 Kanis Road
Little Rock, AR, 72203
5013710272
FAX: 501-371-9932
www.mce.us.com

McClelland Consulting Engineers, Inc., is a regional multi-disciplined consulting engineering firm providing professional civil engineering services including geotechnical engineering, environmental engineering, airport engineering, landscape architecture, and professional land surveying.

MetLife

135 Fontainbleau Drive
Maumelle, AR, 72113
501-734-8344
FAX: 501-734-8319
www.metlife.com

Group Term and Permanent Life—employer and employee (voluntary) paid employer group benefits including retirement plan, education and plan support.

Mitchell Williams

425 West Capitol, Suite 1800
Little Rock, AR, 72201
501-688-8800
www.mitchellwilliamsllaw.com

Mitchell, Williams, Selig, Gates & Woodyard, P.L.L.C. is a full-service corporate law firm that provides strategic counsel to clients in all matters of business transactions, litigation, regulated business, and insurance regulatory matters. Established in 1954, the firm currently employs more than 80 attorneys in Little Rock, Rogers, and Jonesboro, Arkansas and Austin, Texas.

Municipal Impact

P.O. Box 121034
Arlington, TX, 76012
888-551-4815
FAX: 888-551-4815
www.municipalimpact.com

Municipal Impact provides a customizable, mobile-friendly website solution specifically designed for small towns and communities. This affordable website solution allows you to edit and make updates yourselves, upload forms, photos, and send alerts. Secure hosting and unlimited customer support are all included. 'Municipal Impact - Smart Websites for Smart Communities.'

Musco Sports Lighting

100 1st Avenue West
Oskaloosa, IA, 52577
641-673-0411
www.musco.com

Musco Sports Lighting specializes in the design and manufacture of sports lighting.

Neptune Technology Group

406 Tuscany Circle
Maumelle, AR, 72113
334-415-2032
www.neptunetg.com

Neptune Technology Group is a leading U.S. based water meter and AMR/AMI technology manufacturer. Our metering solutions include PD, Ultrasonic, Turbine, and Compound options. Our system solutions include walk-by, drive-by, traditional fixed network, and 4G-LTE cellular fixed network. With over 120 years in the business, you can count on Neptune to be a long-term partner.

NLC Service Line Warranty Program

11 Grandview Circle, Suite 100
Canonsburg, PA, 15317
724-749-1060
FAX: 412-229-4520
www.utilitysp.net

The NLC Service Line Warranty Program partners with nearly 400 cities in North America and has helped more than 400,000 homeowners save over \$33 million in service line repair costs in the last three years. To learn more about this unique program and how it can bring revenue and peace of mind to your community, please contact Emilie Zalfini at ezalfini@utilitysp.net or 724-749-1060 for more information.

Northwest Technical Institute

550 Bain Street
Springdale, AR, 72764
479-306-7969
FAX: 479-306-7969
www.ntibit.com

NTI Business and Industry offers various training for companies as well as individuals. Most classes fall into one of three categories: computer classes, leadership and teamwork classes, and industrial maintenance classes. We also do customized classes.

Office of Attorney General Leslie Rutledge

323 Center Street, Suite 200
Little Rock, AR, 72201
501-682-3645
FAX: 501-682-6704
www.arkansasag.gov

Attorney General Leslie Rutledge is committed to protecting and defending the interests of all Arkansans. The Attorney General is Arkansas's chief law enforcement officer and chief consumer advocate. Our office provides law enforcement resources to include a law enforcement manual, Laura's cards to support victims of domestic violence, and other consumer protection and safety education.

OptumRx

1600 McConnor Parkway
Schaumburg, IL, 60173
630-210-4420
FAX: 480-606-5202
www.optumrx.com

OptumRx is a pharmacy care services company helping clients and more than 65 million members achieve better health outcomes and lower overall costs through innovative prescription drug benefits management services, including custom formulary administration. OptumRx is part of Optum, a leading information and technology-enabled health services business dedicated to making the health system work better for everyone.

PFITR

417 Main Street Avenue,
Suite 310N
Little Rock, AR 72201
501-503-0535
www.pfitr.com

PFITR is a technology company that brings transparency to the bond market. Many fiduciaries are dependent on sales people who sell complex, fixed-income investments and inherent risks in the high commission products they sell. We offer disruptive technology to level the playing field and give fiduciaries the tools to understand risks, get fair market value, and make better fixed-income investments with our guidance and innovative technology.

Power Play, LLC

12818 South Memorial Drive,
Suite 108
Bixby, OK, 74008
918-728-9978
FAX: 918-516-3599
www.power-play.net

Power Play specializes in park and recreation equipment for water playgrounds and commercial customers. We are a supplier for select vendors and we also provide Splashpad planning, design, consulting, training, and maintenance services. We provide Splashpad and water playground equipment, water slides, playground and outdoor fitness equipment, shades and shelters, site furnishings, and safety surfacing.

Precise Data Consulting, LLC

45 Legends Drive
Little Rock, AR, 72210
501-420-4917
FAX: 501-747-1739
precisedataconsulting.com

PDC offers a specialized skill set and expertise in quantitative and qualitative research and evaluation. We provide data services in four main areas: collection, analysis, interpretation, and reporting. These four services integrate to provide the highest quality of research, monitoring, and evaluation.

Precision Safe Sidewalks

P.O. Box 10467
Conway, AR, 72034
844-450-5005
FAX: 844-450-5005
www.SafeSidewalks.com

We make sidewalks safe. Our patented process makes ADA compliant sidewalks, eliminates fall and Trip Hazards, and saves you money. Our surveying and repair service is trusted by thousands of clients in the United States and Canada. We use proprietary technology and equipment to survey and repair sidewalks for a fraction of the cost of sidewalk replacement. We can easily provide the service and data that others can't.

Raymond James

100 Morgan Keegan Drive,
Suite 400
Little Rock, AR, 72202
501-671-1339
FAX: 501-671-1103
www.raymondjames.com

Raymond James Public Finance group has in-depth experience and expertise in providing innovative financing solutions for large and small issuers. We are a dedicated partner to clients across America, including those in state and local governments, airports, utilities, school districts, higher education, and healthcare.

Regions Bank Corporate Trust

400 West Capitol, 7th Floor
Little Rock, AR, 72201
501-371-7246
FAX: 501-371-8827
www.regions.com

Regions Bank Corporate Trust provides trustee and paying agent services for municipal bond financing throughout the state of Arkansas.

River City Hydraulics, Inc.

P.O. Box 6033
Sherwood, AR, 72124
501-835-5230
FAX: 501-834-1233
www.rivercityhyd.com

We are a dealer for garbage trucks, roll-off hoist knuckleboom, loaders, and street sweepers. We also service all kinds of garbage trucks.

RxResults

320 Executive Court, Suite 201
Little Rock, AR, 72205
501-749-9797
FAX: 501-954-7851
www.rxresults.com

RxResults is an evidence-based Risk Management company. We work with our customers to eliminate wasteful pharmacy plan spending for their employees, while providing lower cost options.

Scott Equipment

10923 Interstate 30
Little Rock, AR, 72209
501-455-5955
FAX: 855-814-2502
www.scottcompanies.com

Construction equipment sales, rental, parts, service—Case Construction, Kobelco Excavators, Gradall Excavators, Volvo Construction, Mauldin Paving Products, Superior Brooms, snow and ice equipment, Morbark Chippers, Equipment Trailers, Multiquip Construction Products, Road Hog Reclaimers.

Secretary of State Mark Martin

500 Woodlane Avenue, Suite 265
Little Rock, AR, 72201
501-682-1010
FAX: 501-682-3510
www.sos.arkansas.gov

The Arkansas Secretary of State is charged as an archivist, registrar, and resource through a diverse range of duties—from overseeing the state's elections to collecting franchise tax and caring for the State Capitol. These areas touch each Arkansan in very real ways, whether it's through the officials they elect, the businesses they shop, or the Capitol they visit.

SHI

290 Davidson Avenue
Somerset, NJ, 08873
501-206-8295
www.shi.com

From software and hardware procurement to deployment planning, configuration, data center optimization, IT asset management and cloud computing, SHI offers custom IT solutions for every aspect of your environment.

Sophicity

5815 Windward Parkway,
Suite 302
Alpharetta, GA, 30005
770-670-6940
FAX: 877-437-5758
www.sophicity.com

The League's IT in a Box provides comprehensive technology products and services—from a new website to data backup and more—tailored to the unique needs of Arkansas cities and priced for Arkansas cities.

SoulArt Inc.

1444C Airplane Drive
Benton, AR, 72015
501-602-0682
FAX: 501-912-3479
www.soulartinc.com

SoulArt Inc. is founded by Ryan T. Schmidt, a contemporary stainless steel artist from Bryant, Arkansas. SoulArt provides stainless steel sculptures for logo representation, landscape sculptures, residences, cities, schools, churches, commercial placements, sealed from tabletop center pieces, to monuments in mirror-polish finish to create reflection for inspirational thoughts.

Southern Paramedic

P.O. Box 88
Brinkley, AR, 72021
870-480-6211
FAX: 870-672-9911
www.southernparamedic.com

Southern provides Arkansas-accredited ambulance services in Monroe, Arkansas, Cross, Lonoke, and Van Buren counties and also provides backup to Jacksonville Fire and transfer services to local hospitals. We are available to answer questions regarding emergency or non-emergency transport of the sick and/or injured. Paramedic and basic level services available.

Stephens Inc/AR Diamond Plan

111 Center Street
Little Rock, AR, 72201
501-377-8112
FAX: 501-210-4618
www.stephens.com

All municipalities, and other political subdivisions of the State of Arkansas are eligible to utilize the State of Arkansas Deferred Compensation Plan, commonly referred to as the AR Diamond Plan. The AR Diamond Plan can be made available to employees at no cost to the city. Other plan benefits include a simplified plan structure, low cost and a local service team.

STORMBOX Community Safe Rooms

6601 Scott Hamilton Drive
Little Rock, AR 72209
Ph: 501-562-1267
Fax: 501-562-2824
www.stormbox.us

Large capacity, F5/250 MPH rated tornado shelters for municipalities, schools, large employers, and churches. These safe rooms meet all FEMA and ICC 500 guidelines, install in a few days, and are the least expensive FEMA 361 safe rooms on the market.

Sweeping Corp. of America

713 Melpark Drive
Nashville, TN, 37204
615-385-4422
FAX: 615-385-4798
www.sweepingcorp.com

Sweeping Corporation of America, Inc. contracts street sweeping and storm drain cleaning.

The Belford Group

68 West Sunbridge Drive
Fayetteville, AR, 72703
479-443-9945
FAX: 479-443-9945
www.thebelfordgroup.com

Online payment systems for municipalities and businesses, event registration software, branding, website design, SEO, full-service marketing, graphic design.

The Grant Book Company

P.O. Box 504
Helena, AR, 72342
870-816-5122
FAX: 870-200-6512
www.grantplanet.net

A one-stop source for federal, state, foundation, and corporate grants for Arkansas cities and communities. Stop and register today for this service that is included in your Arkansas Municipal League membership.

The PlayWell Group

4743 Iberia Avenue, Suite C
Dallas, TX, 75207
800-726-1816
FAX: 505-296-8900
www.playwellgroup.com

Since 1988, The PlayWell Group has been establishing an excellent reputation in Arkansas as the premier playground consultant. Seeking to invest in new playground equipment or covering an existing playground? PlayWell provides quality products for outdoor activity, fitness, and play.

TIPS

4845 US Hwy 271 North
Pittsburg, TX, 75686
866-839-8477
FAX: 866-839-8472
www.tips-usa.com

TIPS is a leading national purchasing cooperative offering members access to competitively priced purchasing contracts that save time and money by streamlining the process and leveraging the purchasing power of over 4,800 member agencies. 'Connecting Members and Vendors Together.'

U.S. Census Bureau

3817 Saratogo Drive
Joliet, IL, 60435
312-498-2240
FAX: 630-288-9288
www.census.gov

The U.S. Census Bureau measures America's people, places, and our economy. Visit our booth for information on business and industry, income, population, housing, and more.

Under Scan Technologies

1500 North Locust, Suite D
North Little Rock, AR, 72114
501-753-1009
FAX: 501-753-2780
www.underscanit.com

Concrete scanning/ground penetration radar investigation and data reporting services. Non-destructive subsurface detection.

US Wellness, Inc.

20400 Observation Drive,
Suite 100
Germantown, MD, 21703
301-926-6099
FAX: 301-926-4580
www.uswellness.com

US Wellness is a health education and wellness company that operates internationally. health screenings for total cholesterol, HDL cholesterol, TC/HDL, Ratio, blood pressure, glucose, and counseling.

USDA-NRCS

700 West Capitol Avenue, Room
3416
Little Rock, AR, 72201
501-301-3133
FAX: 855-681-7044
www.nrcs.usda.gov

USDA NRCS provides Arkansas farmers and ranchers with financial and technical assistance to voluntarily put conservation on the ground, not only helping the environment, but agricultural operations too.

USDA Rural Development

700 West Capito Avenue,
Room 3416
Little Rock, AR 72201
501-301-3221
FAX: 855-747-7797
www.rd.usda.gov

Rural Development has a wide range of loan and grant programs available for cities and towns located in rural Arkansas.

Vector Disease Control International

1320 Brookwood Drive, Suite H
Little Rock, AR, 72202
501-280-0220
FAX: 866-839-8595
www.vdci.net

Vector Disease Control International (VDCI) is a world leader in integrated mosquito management (IMM) services. We offer mosquito control and public health services to counties, large cities, and small towns in the United States.

Verizon Wireless

101 Park Avenue, 13th Floor
Oklahoma City, OK, 73102
405-206-7442
FAX: 405-917-0291
www.verizon.com

Wireless telecommunications products and services for state and local government agencies. Wireless solutions designed to reduce expenses, increase productivity, and improve the safety and security of your employees and citizens.

Waste Connections, Inc.

3 Waterway Square Place,
Suite 550
The Woodlands, TX, 77380
832-442-2914
www.wasteconnections.com

Waste Connections is a fully integrated, non-hazardous solid waste service company dedicated to providing high-quality collection, recycling, transportation, and disposal services. The company prides itself on its community involvement, environmental awareness, and a strong commitment to customer service.

Waste Management

4986 Prestwick South Circle
Fayetteville, AR, 72704
501-804-9515
FAX: 866-281-2104
www.wm.com

We're the leading provider of comprehensive waste management services in North America, providing services that range from collection and disposal to recycling and renewable energy generation.

Waste Pro

35 Romine Ave.
Hoxie, AR, 72433
870-886-5434
www.wasteprousa.com

Waste Pro is one of the fastest growing, privately owned solid waste companies, serving nine states and two million customers with commercial and residential solid waste and recycling collection, processing, and disposal services from more than 75 locations. Waste Pro proudly provides service for more than 500 cities in 235 counties throughout our footprint.

Welch State Bank

P.O. Box 129
Welch, OK, 74369
918-788-F2:F1013373
FAX: 918-788-3364
www.welchstatebank.com

The Welch State Bank is a full-service bank specializing in municipal finance. The bank was established in 1929 in northeastern Oklahoma. We started working with municipalities, schools, counties, and fire protection districts over 20 years ago and service Arkansas, Kansas, Missouri, Oklahoma, and Texas. Give us an opportunity to serve you and your city or town. We will put you first.

City & Town

Arkansas Municipal League, P.O. Box 38, North Little Rock, AR 72115-0038
 501-374-3484 • FAX: 501-374-0541 • e-mail: citytown@arml.org • www.arml.org

Specs

Trim size is 8.5" by 11". Line screen is 175 dpi and is printed on 70-lb. coated white stock. The binding is saddle-stitch.

Artwork

City & Town is Macintosh produced. We accept Adobe Illustrator and Adobe Photoshop files in addition to PDFs. PDFs must have all images and fonts embedded and bleed included (if applicable). Color files must be built in four-color process (CMYK). Ads should be submitted by e-mail to citytown@arml.org.

Advertising Rates:

Volume Price Breaks per year	1-5 times a year	6 times a year	12 times a year
Full Page Covers	Color Cover prices are listed below.		
Inside Front	\$590 each	\$540 each	\$490 each
Inside Back	\$560 each	\$505 each	\$455 each
Back Cover	\$635 each	\$580 each	\$530 each
Ads in Color	Color Art prices are listed below.		
Full page	\$555 each	\$490 each	\$430 each
1/2 page	\$405 each	\$385 each	\$370 each
1/4 page	\$320 each	\$305 each	\$290 each
Ads in Grayscale	Grayscale Art prices are listed below:		
Full page	\$375 each	\$310 each	\$250 each
1/2 page	\$225 each	\$205 each	\$190 each
1/4 page	\$140 each	\$125 each	\$110 each

FULL PAGE
WITH BLEED

8.75" wide
X
11.25" tall

1/2 PAGE

HORIZONTAL
7.5" wide
X
5" tall

1/4 Page
Horizontal
3.5" wide
X
5" tall

1/2 PAGE
VERTICAL

3.5" wide
X
10" tall

1/4 Page
Horizontal
3.5" wide
X
5" tall

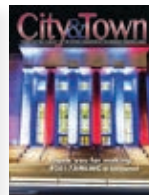

In Memoriam

DEAN RANDALL ADAMS SR., 55, an 11-year employee with the Cherokee Village Street Department, died May 21.

JAMES LEE APPLETON, 59, Gateway street superintendent, died Feb. 23.

ROBERT BAKER, 26, a four-year veteran of the McCrory Police Department, died Sept. 15, 2016.

RONALD GENE "RONNIE" BALDWIN, 63, a Wynne alderman since 2009, former Wynne police officer, chief of police in Brinkley, Cross County sheriff, and who served as president of the Arkansas Sheriffs' Association and on the board of the National Sheriffs' Association, died Aug. 28, 2016.

KEN BARTON, 75, a Lakeview alderman, died Feb. 24.

LEROY BROWN, 79, former Buckner mayor and alderman, died Sept. 26, 2016.

MICHAEL L. BROWN, 57, a Mount Ida alderman for more than 10 years, died July 10, 2016.

DR. PERRY W. BROWN, 88, a Morrilton alderman from 1998-2002, died March 26.

MARTY S. BYERS, 57, mayor of Lexa, died April 19.

PHILLIP O. CARRUTH SR., 75, a former Russellville mayor and alderman, died Sept. 17, 2016.

RALPH MICHAEL CLIFTON, 68, who served as the city attorney for Brinkley for 31 years, died April 20.

JIM CLINKINGBEARD, 89, a former Calico Rock alderman, died March 12.

ROBERT "BOB" COLLINS, 88, a Springdale alderman from 1986 to 1998, died Jan. 29.

LLOYD CUPP 89, who served 52 years as a volunteer fireman including 21 years as fire chief in Morrilton, died June 1, 2016.

DOUG DOOLEY, 57, a Biscoe alderman, died Nov. 14, 2016.

WILLIAM KELLY (DUKE) ELLINGTON, 74, who served over 38 years with the Little Rock Fire Department, retiring as a captain, died Sept. 23, 2016.

BRUCE FOUTCH, 63, a North Little Rock alderman from 2011-2016, died March 29.

DALE FREEMAN, 75, Lawrence County Judge and former mayor of Portia, died Sept. 17, 2016.

FRANK GATLIN, 86, a Paragould alderman who served from 1979-2002, died March 17.

RAY GOSACK, 58, who served as Fort Smith city administrator from 2011 to 2015 after 12 years as the city's deputy city administrator and as administrative assistant from 1985 to 1988, died Oct. 21, 2016.

LARRY OLEN GRIFFIN, 70, husband of Hartman Mayor Rita Griffin, a 16-year employee of Clarksville's street and parks departments, and Johnson County road superintendent for 18 years, died April 30.

BOBBY HALE, 52, former Shannon Hills police chief, died March 8.

DANNY HOLLOWAY, 76, a longtime Georgetown alderman, died Aug. 9, 2016.

SAMUEL DALE "SAM" JEFFERY, 51, a Rogers councilmember, died March 9.

SHARRON JOY, 69, a Paragould alderman who served from 1999-2013, died March 23.

JAMES EDGAR MURPHY, 65, North Little Rock fire chief from 2014-2017, died March 18.

DAVID NELSON, 57, a Beebe police officer who had worked for the city for 38 years in various capacities, including working for the street department, parks department, and as a volunteer fireman, died Sept. 24, 2016.

DARRELL RAY NEWTON, 83, who served for 16 years as mayor of Hackett as well as serving as an alderman, died Feb. 17.

ROBERT D. NORRIS, 71, a Clarksville alderman and a retired police officer for the city, died Nov. 22, 2016.

WILLIE J. PATTERSON, 68, Parkin mayor and a former alderman, died Dec. 17, 2016.

TYRONE ROGERS, 53, a Fayetteville employee on the city's telecasting team, died June 6, 2016.

LEE ALISON SCHOONOVER, 69, a Ward alderman, died Jan. 21.

REBECCA "BECKY" POWERS (HENRY) SHORT, 79, a Beebe council member since 2007 and the city's clerk/treasurer from 1991-2002, died Sept. 8, 2016.

HUGH DAY WELCH, 72, a former Malvern alderman, died July 20, 2016.

RALPH D. WELLS, 80, seven-term mayor and former councilmember of Leachville, died May 25.

ANDREW EUGENE WILLARD, 61, former mayor of Amagon, died Aug. 11, 2016.

JOYCE ZELLER, 84, a longtime Eureka Springs alderman, died June 13, 2016.



www.arml.org



[Facebook.com/Arkansas.Municipal.League](https://www.facebook.com/Arkansas.Municipal.League)



[Twitter @ARMuniLeague](https://twitter.com/ARMuniLeague)



[Linkedin Arkansas Municipal League](https://www.linkedin.com/company/Arkansas Municipal League)



[Instagram armunileague](https://www.instagram.com/armunileague)



[Youtube.com/user/ARMunicipalLeague](https://www.youtube.com/user/ARMunicipalLeague)



[Flickr.com/photos/arkansas_municipal_league](https://www.flickr.com/photos/arkansas_municipal_league)



greatcitiesgreatstate.com (microsite)

P.O. Box 38, North Little Rock, AR 72115

301 W. Second St., North Little Rock, AR 72114

501-374-3484

#83rdAMLConv